



## Kingshill Drive

Kenton, Harrow, HA3 8QT

**£1,450,000**

A truly exceptional and individually designed five / six bedroom detached residence, boasting a 44' reception room, 23' x 22' kitchen/diner, four bedrooms, master bedroom suite, including dressing room an ensuite shower room/wc, elegant open plan winding staircase, all built with high quality materials and workmanship providing a luxurious family home. Located close to Belmont Circle for shops, bus stops, Priestmead Primary School and with the nearest station being at Canons Park. EPC Rating: Awaiting.



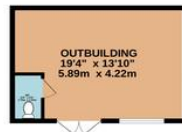

TOTAL FLOOR AREA : 3776 sq.ft. (350.8 sq.m.) approx.

Whilst every attempt has been made to ensure the accuracy of the floorplan contained here, measurements of doors, windows, rooms and any other items are approximate and no responsibility is taken for any error, omission or mis-statement. This plan is for illustrative purposes only and should be used as such by any prospective purchaser. The services, systems and appliances shown have not been tested and no guarantee as to their operability or efficiency can be given.

Made with Metropix ©2022



EPC Rating: to be confirmed

Belmont Circle Office  
506 Kenton Lane  
Harrow  
Middlesex  
HA3 8RD

[www.blacklarsestateagents.co.uk](http://www.blacklarsestateagents.co.uk)  
0208 907 7701  
[sales@blacklarsestates.co.uk](mailto:sales@blacklarsestates.co.uk)

Agents Note: Whilst every care has been taken to prepare these particulars, they are for guidance purposes only. All measurements are approximate and are for general guidance purposes only and whilst every care has been taken to ensure their accuracy, they should not be relied upon and potential buyers/tenants are advised to recheck the measurements