



## Clos Yr Alarch, offers in excess of £325,000

- AN EXTENDED SEMI-DETACHED
- FOUR BEDROOMS
- EN-SUITE AND CLOAKROOM
- LONG DRIVEWAY AND GARAGE
- GUIDE PRICE £330,000 TO £340,000
- EPC Rating: C



 4  2  1





## About the property

An extended four bedroom semi-detached property situated in a cul-de-sac within close proximity to schools, shops and public transport. The property benefits from a downstairs cloakroom, a large kitchen/breakfast room overlooking the garden, an en-suite.

### Hall

Double glazed door, stairs, radiator, carpet.

### Cloakroom

Double glazed window, wash hand basin, radiator, carpet.

## Accommodation

### Lounge

14' 4" Max x 12' 6" Max ( 4.37m Max x 3.81m Max )

Double glazed window to front, tv point, carpet, radiator.

### Kitchen/ Diner

15' 7" Max x 10' Max ( 4.75m Max x 3.05m Max )

Window and patio doors, deep understairs cupboard, modern wall and base units, wine rack, plumbing for washing machine, wall mounted Ideal boiler, stainless steel gas hob, electric oven and cooker hood. Space for table and chairs, radiator, tile effect laminate floor.

### Landing

Fitted storage, carpet, skimmed ceiling.





### Master Bedroom

15' 8" Max x 12' 8" Max ( 4.78m Max x 3.86m Max )

Accessed via small landing area. Situated on the second floor. Double glazed window, double glazed skylight, under-eave storage, radiator, carpet, skimmed ceiling and spot lights.

### En Suite

Skylight, low level w.c, vanity unit and wash hand basin with storage, shower cubicle, towel radiator, vinyl flooring, vented.

### Bedroom Two

9' 1" widens to 15'8 x 8' 8" Max ( 2.77m widens to 15'8 x 2.64m Max )

Two double glazed windows, one with deep sill. Radiator, carpet, skimmed ceiling.

### Bedroom Three

9' 4" Max x 8' 11" Max ( 2.84m Max x 2.72m Max )

Double glazed window, radiator, carpet, skimmed ceiling.

### Bedroom Four

8' 11" Max x 6' Max ( 2.72m Max x 1.83m Max )

Double glazed window, radiator, fitted carpet, skimmed ceiling.

### Bathroom

Double glazed window, panelled bath and shower, pedestal wash hand basin, w.c, towel radiator, tiled floor, skimmed ceiling, vented, shaver point.

### Front

Laid to lawn, covered porch, driveway.

### Rear

Lawned, patio, enclosed fencing, shrub beds, side access.

### Detached Garage

Up and over metal door, side courtesy door.

## Floorplan

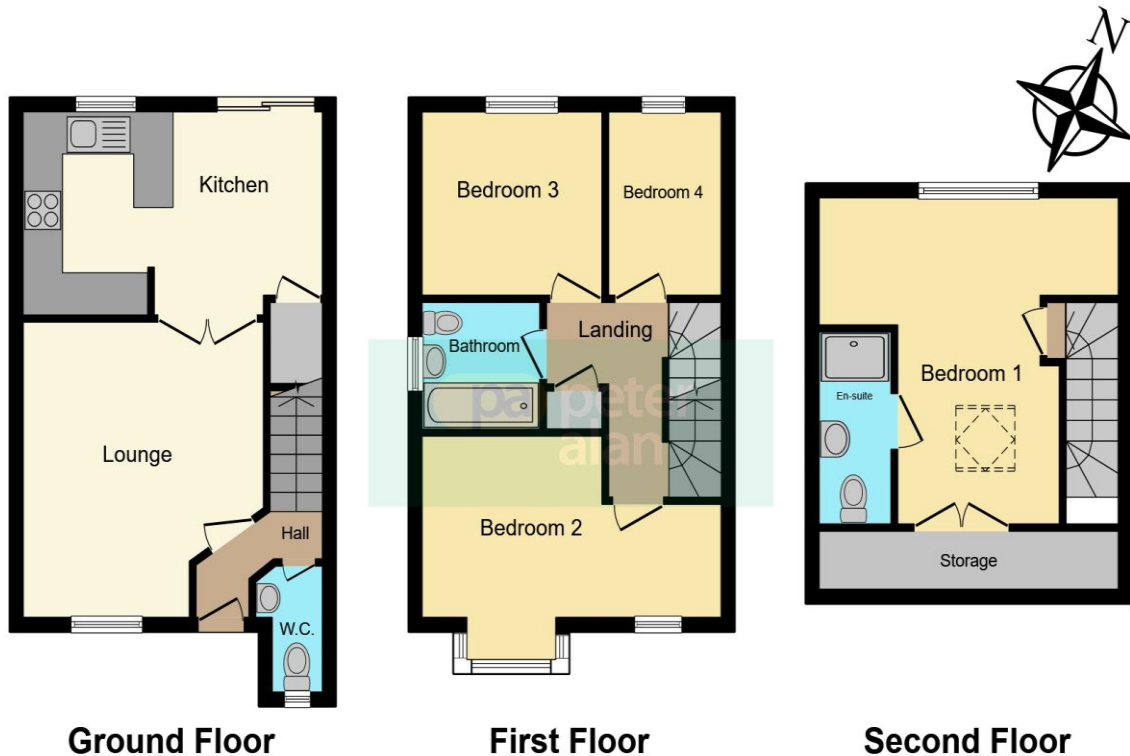

This floorplan is for illustrative purposes only and is not drawn to scale. Measurements, floor-areas, openings and orientations are approximate. They should not be relied upon for any purpose and do not form any part of an agreement. No liability is taken for any error or mis-statement. All parties must rely on their own inspections.

## Important Information

Note while we endeavour to make our sales details accurate and reliable, if there is any point which is of particular interest to you, please contact the office and we will be pleased to confirm the position for you. We have not personally tested any apparatus, equipment, fixtures, fittings or services and cannot verify they are in working order or fit for their purposes. Nothing in these particulars is intended to indicate that carpets or curtains, furnishings or fittings, electrical goods (whether wired or not). Gas fires or light fittings or any other fixtures not expressly included form part of the property offered for sale. This computer generated Floorplan, if applicable, is intended as a general guide to the layout and design of the property. It is not to scale and should not be relied upon for dimensions. Tenure: We cannot confirm the tenure of the property as we have not had access to the legal documents. The buyer is advised to obtain verification from their solicitor or surveyor.

Peter Alan Limited is registered in England and Wales under company number 2073153, Registered Office is Cumbria House, 16-20 Hockliffe Street, Leighton Buzzard, Bedfordshire, LU7 1GN. VAT Registration Number is 500 2481 05. For activities relating to regulated mortgages and non-investment insurance contracts, Peter Alan Limited is an appointed representative of Connells Limited which is authorised and regulated by the Financial Conduct Authority. Connells Limited's Financial Services Register number is 302221. Most buy-to-let