



**187 Christleton Road ,
Chester**
OFFERS OVER
£200,000





This elevated mid terraced home would make a fantastic first time home being a short walk away from a great range of shops & facilities whilst also being on a regular bus service to the City.

The property has been well improved in recent years with the addition of new kitchen and boiler whilst having a spacious first floor bathroom with both a shower and bath.

There is a pleasant front garden with on road parking opposite with the rear garden being easy to maintain being a pleasant patio/entertaining area.

The accommodation comprises; spacious living room with a feature fireplace, 17ft wide dining kitchen with a stylish range of light grey gloss finished units with integrated cooking appliances.

To the first floor there are two good double bedrooms with the front bedroom enjoying an elevated feel with a large recess ideal for hanging space.

There are UPVC double glazed doors and windows throughout.

FINER POINTS





- * Elevated mid terraced home with two double bedrooms
- * Private, low maintenance rear patio/seating area ideal for a barbeque
- * Large main bathroom with a fully tiled shower and separate bath
- * Loft with a pull down ladder
- * Recently installed gas combination boiler
- * Great first time home or investment property

These particulars are intended to give a fair and substantially correct overall description for the guidance of intending purchasers and do not constitute an offer or part of a contract. Prospective purchasers ought to seek their own professional advice. All descriptions, dimensions, areas, reference to condition and necessary permissions for use and occupation and other details are given in good faith and are believed to be correct, but any intending purchasers should not rely on them as statements or representations of fact, but must satisfy themselves by inspection or otherwise as to the correctness of each of them. All measurements are approximate.

Tenure: Freehold

Local Authority: Cheshire West and Chester Council

Council Tax: Band B

Viewings: By appointment only

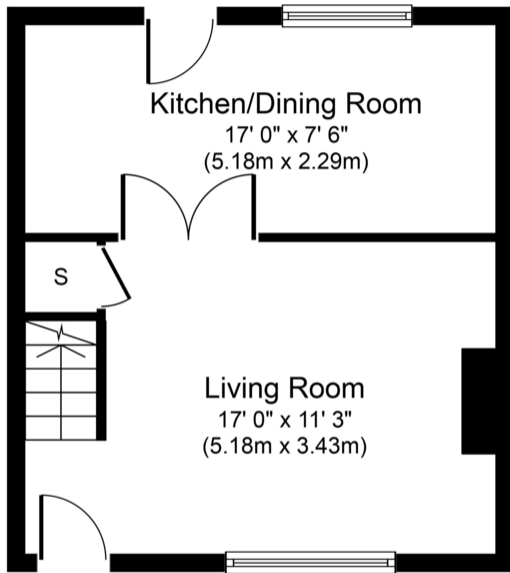

Ground Floor
Approximate Floor Area
324 sq. ft.
(30.1 sq. m.)

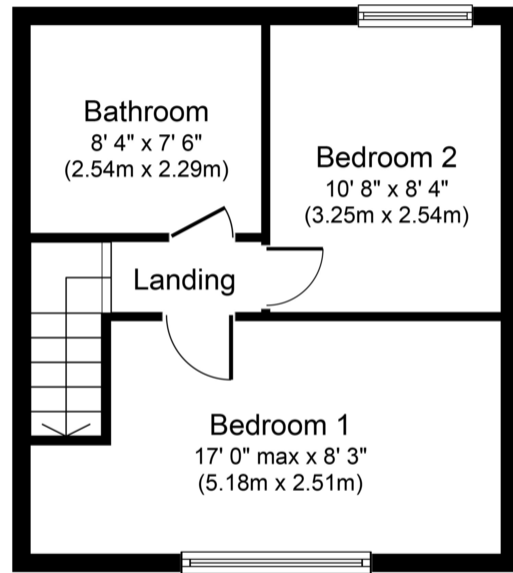

First Floor
Approximate Floor Area
324 sq. ft.
(30.1 sq. m.)

Whilst every attempt has been made to ensure the accuracy of the floor plan contained here, measurements of doors, windows, rooms and any other items are approximate and no responsibility is taken for any error, omission, or mis-statement. The measurements should not be relied upon for valuation, transaction and/or funding purposes. This plan is for illustrative purposes only and should be used as such by any prospective purchaser or tenant. The services, systems and appliances shown have not been tested and no guarantee as to their operability or efficiency can be given.

Copyright V360 Ltd 2023 | www.houseviz.com

Office Address

11 Grosvenor Street
Chester, Cheshire
CH1 2DD

01244 313900

sales@curranshomes.co.uk

