



Seymours



Beta Road  
Farnborough, GU14 8PH  
£540,000

Arrange a viewing: 01276 534100

## Property Details

 5 bedrooms

 2 baths

 EPC Rating TBC

 1520 sqft

 Farnborough Main (1.8 miles)

- Beautifully presented extended home
- Four/fivebedrooms
- Spacious living room with fireplace
- South facing rear garden
- Annexe potential
- Driveway and carport
- Refitted bathrooms
- Council tax band D
- 

A beautifully presented family home which offers flexible and adaptable accommodation. Downstairs the hallway leads to an attractive living room with bay window to the front aspect and an attractive fireplace. To the rear is a spacious conservatory which is heated and currently used as a dining room. There is also a modern kitchen. Over the years the property has been extended to the right hand side at the rear and this offers a shower room as well as a study and another room which is currently arranged as a double bedroom but could easily serve as a family room or play room. Upstairs there are four bedrooms as well as a modern family bathroom. To the rear of the house is an attractive lawned garden with a patio and sitting area. There is also driveway parking to the front as well as a Carport.

[01276 534100](tel:01276534100) / [james@seymours-blackwater.co.uk](mailto:james@seymours-blackwater.co.uk)



### Beta Road

Approximate Gross Internal Area  
Ground Floor = 89.9 sq m / 968 sq ft  
First Floor = 51.3 sq m / 552 sq ft  
Total = 141.2 sq m / 1520 sq ft

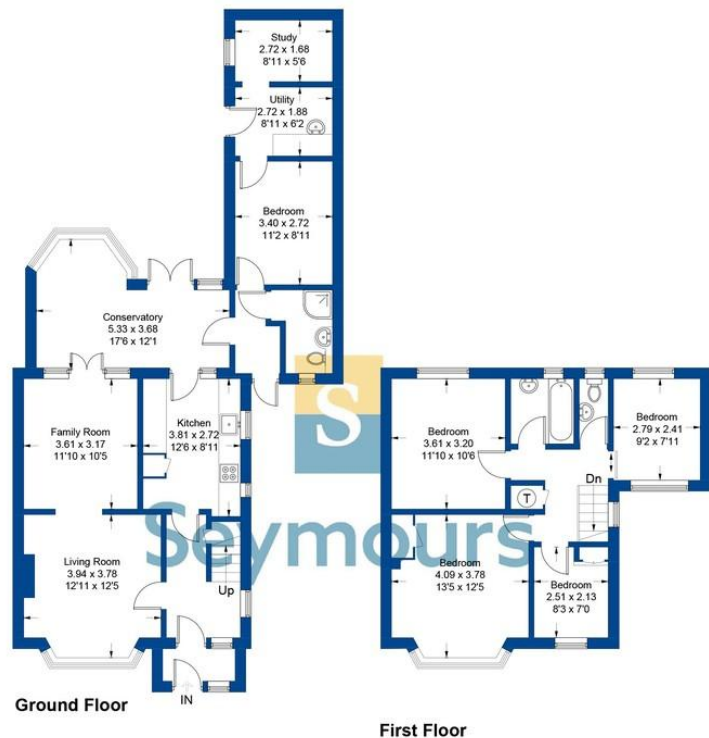

Illustration for identification purposes only, measurements are approximate, not to scale. FloorplansUsketch.com © 2023 (ID1032145)