



Seymours



Frogmore Road  
Camberley, GU17 0DB  
£600,000 Guide Price

Arrange a viewing: 01276 534100

## Property Details

-  5 bedrooms
-  3 baths
-  EPC Rating TBC
-  1652 sqft
-  Blackwater (1.1 miles)

- NO CHAIN
- Four bedrooms
- Three receptions
- Study
- Scope to modernise and improve
- Located in the sought after Frogmore area
- Plenty of parking
- Wrap around garden
- Good local schools

A charming 5-bedroom character coach house located in the heart of Frogmore. This delightful and quirky character home features two spacious living rooms and a kitchen breakfast room as well as a study, offering flexible living space to suit your lifestyle, while a wraparound mature garden provides a pleasant outdoor retreat. With the convenience of driveway parking, you'll have easy access to your vehicles. Nestled in the local area close to Blackwater and the local amenities this property is a home that balances comfort and character whilst giving the incoming purchaser scope to modernise and improve to their tastes. Don't miss the opportunity to make this intriguing coach house your new home!

[01276 534100](tel:01276534100) / [james@seymours-blackwater.co.uk](mailto:james@seymours-blackwater.co.uk)



### Frogmore Road

Approximate Gross Internal Area = 153.4 sq m / 1652 sq ft

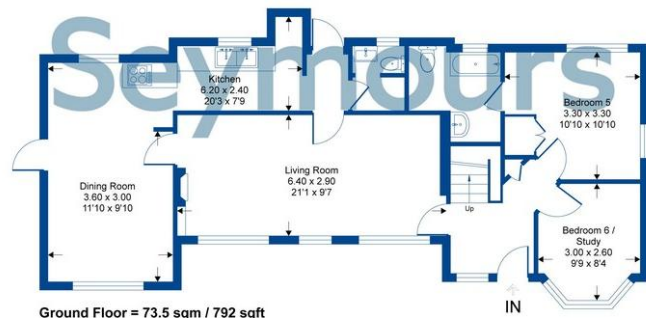

Whilst every attempt has been made to ensure the accuracy of the floor plan contained here, measurements of doors, windows, rooms and any other items are approximate and no responsibility is taken for any error, omission or mis-statement. This plan is for illustrative purposes only and should be used as such by any prospective purchaser.