

87 Church Walk

Worthing BN11 2ND

Asking Price Of £500,000

- FOUR BEDROOMS
- BATHROOM
- SHOWER ROOM
- LIVING ROOM

- KITCHEN
- DINING ROOM
- SITTING ROOM
- REAR PATIO GARDEN

Whitlock and Heaps are pleased to bring to market this Victorian bay fronted property offering spacious four bedroom accommodation with three separate reception rooms to the ground floor. The house offers prospective buyers the opportunity to extend (stnc) and refurbish throughout with the house also featuring a private patio garden with rear access. Situated to the East of Worthing, this perfectly situated property is less than 350 metres to the seafront and is close to local schools and parks. Worthing town centre with its comprehensive shopping amenities, restaurants, pubs, cinemas, theatres and leisure facilities is less than one mile away. The nearest station is East Worthing which is less than half a mile away and bus services run nearby to Brighton, Chichester and Portsmouth.

ENTRANCE HALL Radiator, understairs cupboard.

KITCHEN Incorporating stainless steel sink unit with drainer, adjacent laminate work surface with cupboard and drawers under, matching eye level wall cupboards, inset four ring ceramic hob, electric oven, fridge/freezer and washing machine, tiled splashback, UPVC double glazed window, tiled floor.

DINING ROOM UPVC double glazed window, radiator, wall mounted boiler, hot water cylinder.

LIVING ROOM Feature fireplace, UPVC double glazed bay window, radiator.

SITTING ROOM UPVC double glazed window, radiator.

INNER HALL Tiled floor, radiator, door to garden.

SHOWER ROOM Comprising walk in shower, pedestal wash hand basin, low level w.c, UPVC double glazed window, tiled floor.

FIRST FLOOR

LANDING Hatch to loft space, cupboard.

BEDROOM 1 UPVC double glazed window, second window to side, sink with cupboard under, radiator.

BEDROOM 2 Sink with cupboard under, radiator, UPVC double glazed window.

BEDROOM 3 Sink with cupboard under, UPVC double glazed window, radiator.

BEDROOM 4 UPVC double glazed window, cupboard, radiator.

BATHROOM Comprising panelled bath, pedestal wash hand basin, UPVC double glazed window, radiator, part tiled walls.

SEPARATE W.C Low level w.c, UPVC double glazed window.

OUTSIDE

FRONT GARDEN

REAR GARDEN Paved with gate offering rear access.

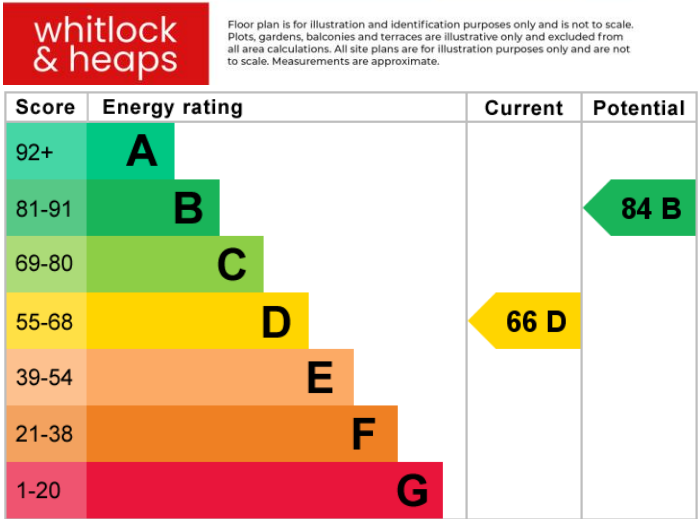
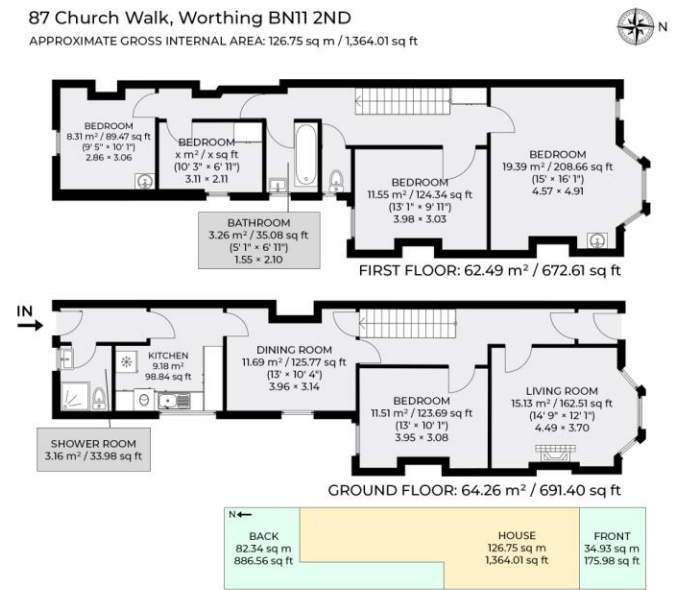

65 Sackville Road, Hove BN3 3WE
sales@whitlockandheaps.co.uk
01273 778577



Disclaimer: Whitlock & Heaps have produced these particulars in good faith and they are set out as a general guide. Accuracy is not guaranteed, nor do they form part of any contract. If there is any particular aspect of these details which you require any confirmation, please do contact us, especially if contemplating a long journey. All measurements are approximate. Fixtures and fittings, other than those mentioned above, to be agreed with the seller. Any services, systems or appliances at the property have not been tested.