



Cricklewood Lane, London

£1,450 pcm

Mile are pleased to bring to market this one bedroom apartment with private garden

- Ground floor apartment
- One bedroom
- Private garden
- Own entrance
- Furnished
- Available early July 2025
- Good condition
- Great condition
- Walking distance to transport
- Close to shops and restaurants



Cricklewood Lane, NW2

CAPTURE DATE 26/09/2022 LASER SCAN POINTS 144,071,031

GROSS INTERNAL AREA

34.87 sqm / 375.34 sqft

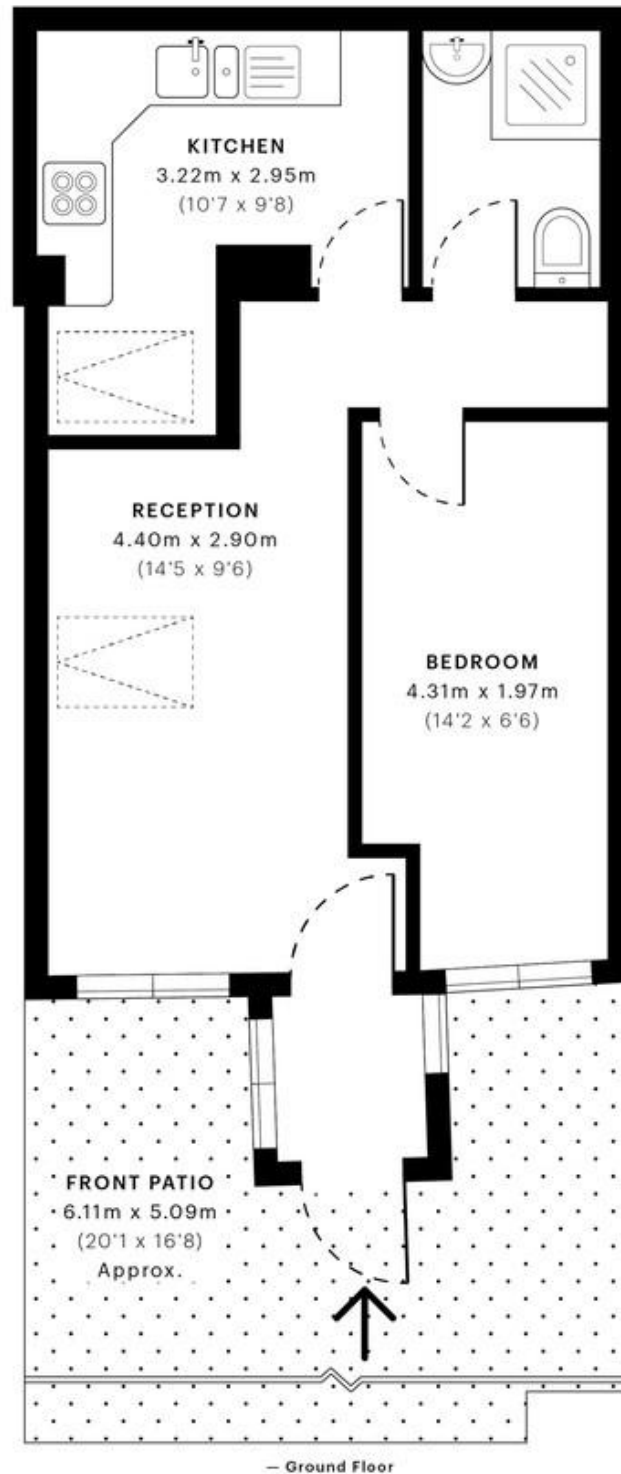

— Ground Floor

GROSS INTERNAL AREA (GIA)
The footprint of the property
34.87 sqm / 375.34 sqft

NET INTERNAL AREA (NIA)
Excludes walls and external features
Includes alcoves, restricted head height
32.51 sqm / 349.93 sqft

EXTERNAL STRUCTURAL FEATURES
Balconies, terraces, verandas etc.
0.00 sqm / 0.00 sqft

RESTRICTED HEAD HEIGHT
Limited open areas under 2.0 m
0.00 sqm / 0.00 sqft

Specified floor plans are produced in accordance with

ENFS 50:2020/2021 34.87 sqm / 375.34 sqft

MONEY LAUNDERING REGULATIONS 2003: Intending purchasers will be asked to produce identification documentation at a later stage and we would ask for your co-operation in order that there will be no delay in agreeing the sale.

General: While we endeavour to make our sales particulars fair, accurate and reliable, they are only a general guide to the property and, accordingly, if there is any point which is of particular importance to you, please contact the office and we will be pleased to check the position for you, especially if you are contemplating travelling some distance to view the property.

Measurements: These approximate room sizes are only intended as general guidance. You must verify the dimensions carefully before ordering carpets or any built-in furniture.

Services: Please note we have not tested the services or any of the equipment or appliances in this property, accordingly we strongly advise prospective buyers to commission their own survey or service reports before finalising their offer to purchase.