

Tel: 01923 677755
Fax: 01923 680729

www.claytons.co.uk

Claytons 



MEADOW ROAD, WATFORD - £550,000
3 Bedroom Semi-Detached House



A wonderfully kept three-bedroom semi-detached house which has been extended to the ground floor but still offers plenty of scope for further extension (STPP). On the ground floor you will find a living room with doors leading into the dining room, extended fitted kitchen and a guest's WC. On the first floor are three bedrooms with a family bathroom and separate WC. Externally you will find a stunning rear garden which provides ample space for entertaining including patio area leading to lawn with pretty flower and shrub borders, there is a summer house and a large garage at the rear with a further large storage unit. Call now to book a viewing.

- Three bedrooms
- Semi detached
- Stunning garden
- Garage and further storage
- Parking to front
- Wonderful condition throughout

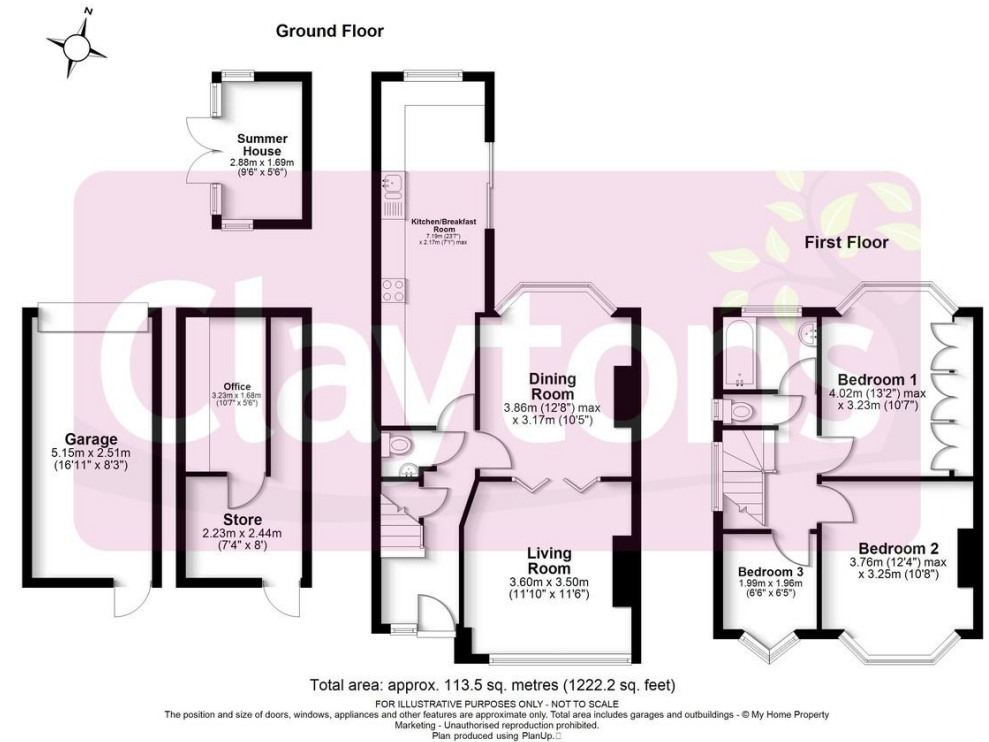

 VIEWING BY APPOINTMENT THROUGH CLAYTONS 01923 677755

FREE VALUATIONS & MARKETING ADVICE

Can we assist you in the sale of your property? If your home is situated within the catchment area of one of our sales offices we would be pleased to offer you a free valuation and market appraisal, a service which we provide without obligation. Competitive fees are always available for both sole and multiple agency. Please contact David Clayton on 01923 677755.

NB 1) We have not tested any appliances and/or services mentioned in these property particulars and do not intend to imply they are in full working order. Photographs are for illustrative purposes only and may show items that are not included in the sale of this property. 2) Due to Money Laundering Regulations 2003 we will ask all prospective purchasers for identification. 3) Buyers should seek verification from their solicitor about the legal title of this property.

These particulars are intended only to give fair description of the property, as a guide to prospective buyers. Accordingly, a) their accuracy is not guaranteed and neither Claytons nor the Vendor(s) accept any liability in respect of their contents; b) they do not constitute an offer or contract of sale, and c) any prospective purchaser should satisfy themselves by inspection or otherwise as to the correctness of any statements or information on these particulars.

Claytons & Hayes Ltd • Registered in England No. 2655243 • Registered Office: 4 Garston Park Parade, Garston, Watford, Herts WD25 9LQ • vat No. 579331903

See all our properties at www.claytons.co.uk

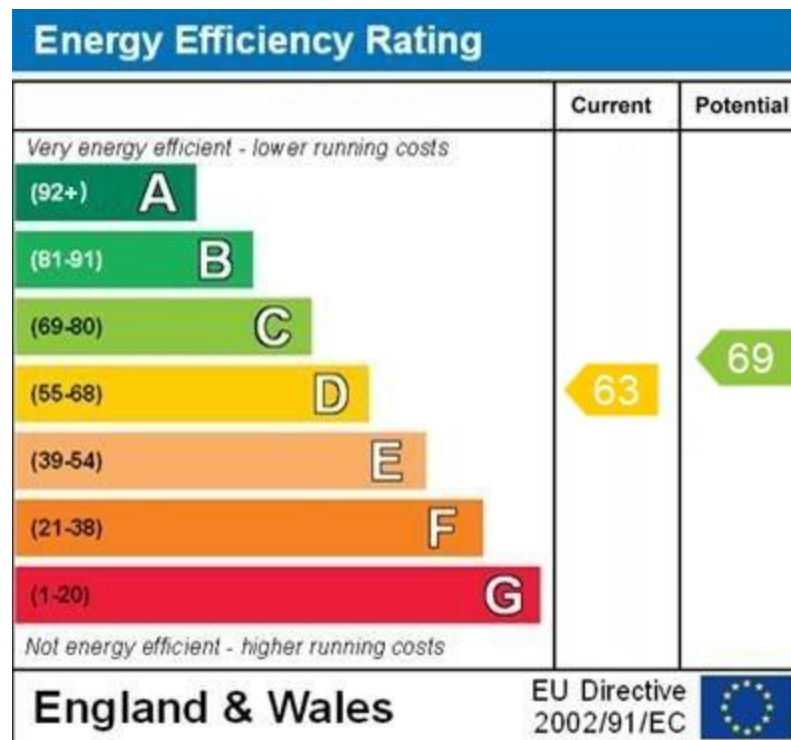

WWW.EPC4U.COM