



St. Pauls Road, Peterborough    **£169,500**





YOUR MOVE





St. Pauls Road,  
Peterborough

**£169,500**

### Property Description

In a set back position this bungalow with its entrance hall, kitchen/diner, lounge, 2 bedrooms, family bathroom, off road parking, garage and spacious garden needs to be viewed to appreciate the plot. A copy of the EPC will be available on request. EPC grade C.

### Our View

If you are a family who enjoys BBQ's then this garden is waiting.

### Location

New England is a suburb of Peterborough, located within a few minutes drive of the City Centre and all its amenities. Dogsthorpe also benefits from its own local shops and school, gym and a Tesco Metro Store. Peterborough is a city in Cambridgeshire and is approximately 45 minutes away from both Leicester and Cambridge. Peterborough has excellent transport links with a mainline train service to London King's Cross, and the A1 running past the city providing links to the North and the South.



**EPC Grade C**

**For full EPC please contact the branch**

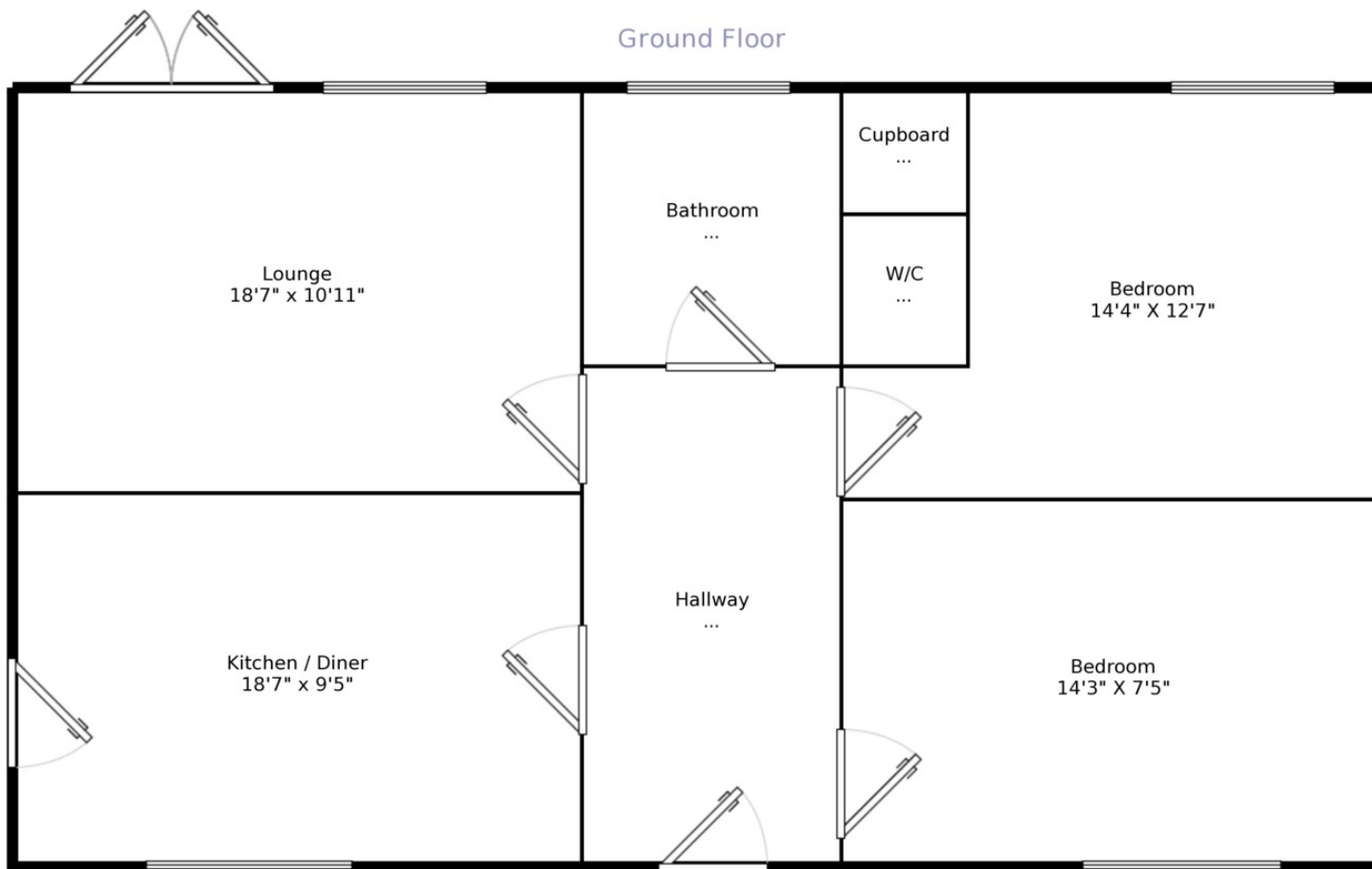

Measurements are approximate. Not to scale. For illustrative purposes only.

IMPORTANT NOTE TO PURCHASERS: We endeavour to make our sales particulars accurate and reliable, however, they do not constitute or form part of an offer or any contract and none is to be relied upon as statements of representation or fact. The services, systems and appliances listed in this specification have not been tested by us and no guarantee as to their operating ability or efficiency is given. All measurements have been taken as guide to prospective buyers only, and are not precise. Floor plans where included are not to scale and accuracy is not guaranteed. If you require clarification or further information on any points, please contact us, especially if you are travelling some distance to view. Fixtures and fittings other than those mentioned are to be agreed with the seller.

Your Move is a trading name of your-move.co.uk, registered in England at Newcastle House, Albany Court, Newcastle Business Park, Newcastle upon Tyne NE4 7YB (number 01864469).

42 Cowgate, Peterborough, PE1 1NA

01733 558855 \* [Peterborough@your-move.co.uk](mailto:Peterborough@your-move.co.uk)

\*Calls may be recorded and/or monitored for training and/or security purposes.

