



Vicarage Court, Earl Shilton, LEICESTER **Offers Over £70,000**





YOUR MOVE





Vicarage Court, Earl Shilton, LEICESTER

Offers Over £70,000

Property Description

New to the market is this spacious ground floor apartment in sought after village location offering excellent public transport nearby. The Apartment benefits from a newly fitted kitchen and bathroom and is likely to appeal to buyers from a wide section of the market. Accommodation comprises entrance hall, lounge, kitchen, bedroom and bathroom. Externally there is a garden to front with allocated parking to rear. Early viewing is strongly recommended. EPC grade D.

Our View

This beautifully presented ground floor apartment is perfect for those either downsizing or taking their first step onto the property ladder. With little or no maintenance to be considered and excellent transport links close by its a must view and soon before its gone!

Location

Earl Shilton is situated on the outskirts of Hinckley and bordering Barwell and Leicester, with excellent transport links this is an ideal location for the busy commuter. Earl Shilton has a variety of shops that include acclaimed restaurants, public houses, chemists and a convenience store.



One Double Bedroom Apartment
For full EPC please contact the branch

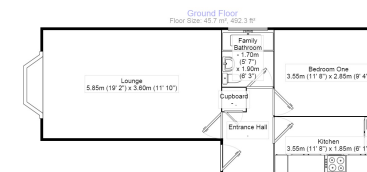

Measurements are approximate. Not to scale. For illustrative purposes only.

IMPORTANT NOTE TO PURCHASERS: We endeavour to make our sales particulars accurate and reliable, however, they do not constitute or form part of an offer or any contract and none is to be relied upon as statements of representation or fact. The services, systems and appliances listed in this specification have not been tested by us and no guarantee as to their operating ability or efficiency is given. All measurements have been taken as guide to prospective buyers only, and are not precise. Floor plans where included are not to scale and accuracy is not guaranteed. If you require clarification or further information on any points, please contact us, especially if you are travelling some distance to view. Fixtures and fittings other than those mentioned are to be agreed with the seller.

Your Move is a trading name of your-move.co.uk, registered in England at Newcastle House, Albany Court, Newcastle Business Park, Newcastle upon Tyne NE4 7YB (number 01864469).

*Calls may be recorded and/or monitored for training and/or security purposes.

Residential, 84 Castle Street, Hinckley,
Leicestershire, LE10 1DD

01455 615908 * Hinckley@your-move.co.uk

