



Moira Close, Stainforth, Doncaster, South Yorkshire **Offers Around £90,000**





YOUR MOVE





Moira Close, Stainforth,
Doncaster, South
Yorkshire

Offers Around £90,000

Property Description

**** GUIDE PRICE £90,000 - £95,000 **** Situated in a popular location of Stainforth is this three bedroom semi detached house. The property is of an open aspect to the ground floor along with three bedrooms to the first floor. The property briefly comprises to the ground floor an entrance porch, living room and an open plan kitchen/diner, to the first floor are three good size bedrooms along with a family bathroom. Externally the property has off street parking, front garden, rear enclosed garden. Also the property benefits from gas central heating and double glazing. A copy of the EPC will be available on request. EPC grade D.

Our View

Offering spacious modern living throughout and being close to local amenities this property will not be around for long. Book your viewing early to avoid disappointment.

Location

Stainforth can be found approximately ten miles to the north east of Doncaster town centre and is serviced by an excellent range of local amenities including shops, schools, public houses and supermarkets, as well as bus services to and from Doncaster town centre. There is also a train station point and motorway access points to the nearby junctions 4 and 5 for the M18.



EPC Grade D

For full EPC please contact the branch

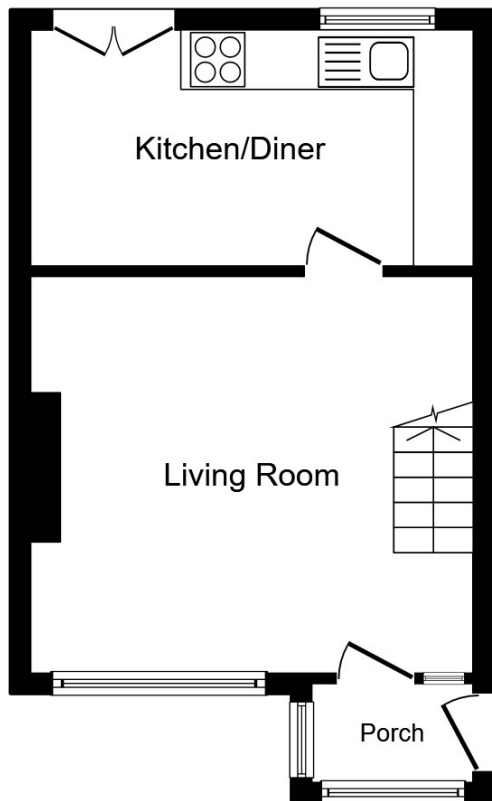

Ground Floor

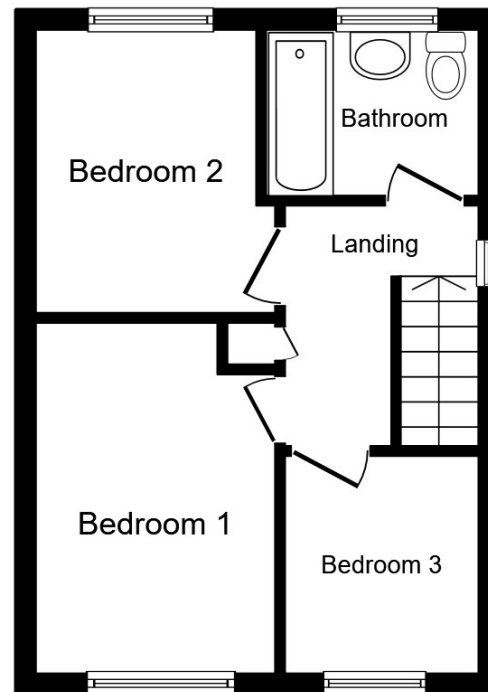

First Floor

This plan is for illustration purposes only and may not be representative of the property. Plan not to scale.

Powered by audioagent.com

IMPORTANT NOTE TO PURCHASERS: We endeavour to make our sales particulars accurate and reliable, however, they do not constitute or form part of an offer or any contract and none is to be relied upon as statements of representation or fact. The services, systems and appliances listed in this specification have not been tested by us and no guarantee as to their operating ability or efficiency is given. All measurements have been taken as guide to prospective buyers only, and are not precise. Floor plans where included are not to scale and accuracy is not guaranteed. If you require clarification or further information on any points, please contact us, especially if you are travelling some distance to view. Fixtures and fittings other than those mentioned are to be agreed with the seller.

Your Move is a trading name of your-move.co.uk, registered in England at Newcastle House, Albany Court, Newcastle Business Park, Newcastle upon Tyne NE4 7YB (number 01864469).

*Calls may be recorded and/or monitored for training and/or security purposes.

Estate House, 56 Hall Gate, Doncaster, South
Yorkshire, DN1 3NE

01302 340444 * Doncaster@your-move.co.uk

