



Queen Street, Aspatria, Wigton, Cumbria **Offers in the region of £70,000**





YOUR MOVE





Queen Street, Aspatria,
Wigton, Cumbria

**Offers in the region of
£70,000**

Property Description

This lovely mid terrace house has a garage, garden and parking and is situated within the town of Aspatria. The property which has views to the Lakeland Fells in the distance from the rear elevation benefits from gas central heating and double glazing and briefly comprises spacious living room with feature fire surround and coal fire, a kitchen/dining room with a range of base and wall units and space for table and chairs, there are two bedrooms and a bathroom/wc with a modern suite Viewing is recommended. EPC grade D.

Our View

Viewing of this property is well worthy of a viewing to appreciate the accommodation and is suitable for a first time buyer or an investor.

Location

The town Aspatria is approximately nine miles from the towns of Wigton and Cockermouth, approximately twenty miles from the border city of Carlisle, approximately four miles from the Solway coast and approximately nine miles north of the Lake District National Park. Within the town of Aspatria there are amenities to include shops, churches, hairdressers, schools and road and rail links to both east and west Cumbria and other facilities.



EPC Grade D

For full EPC please contact the branch

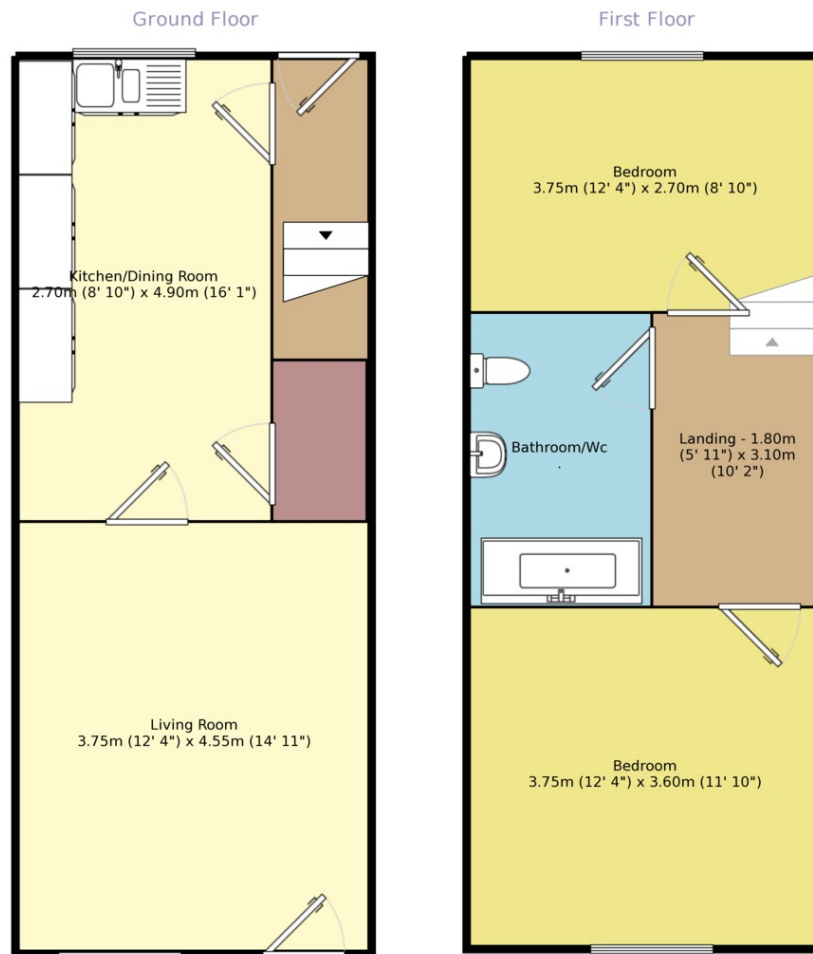

Measurements are approximate. Not to scale. For illustrative purposes only.

IMPORTANT NOTE TO PURCHASERS: We endeavour to make our sales particulars accurate and reliable, however, they do not constitute or form part of an offer or any contract and none is to be relied upon as statements of representation or fact. The services, systems and appliances listed in this specification have not been tested by us and no guarantee as to their operating ability or efficiency is given. All measurements have been taken as guide to prospective buyers only, and are not precise. Floor plans where included are not to scale and accuracy is not guaranteed. If you require clarification or further information on any points, please contact us, especially if you are travelling some distance to view. Fixtures and fittings other than those mentioned are to be agreed with the seller.

Your Move is a trading name of your-move.co.uk, registered in England at Newcastle House, Albany Court, Newcastle Business Park, Newcastle upon Tyne NE4 7YB (number 01864469).

King Street, Wigton, Cumbria, CA7 9DT
016973 44797 * Wigton@your-move.co.uk

*Calls may be recorded and/or monitored for training and/or security purposes.

