



Pentland Terrace, High Valleyfield, Dunfermline, Fife **Offers Over £45,000**





YOUR MOVE





Pentland Terrace, High Valleyfield, Dunfermline, Fife

Offers Over £45,000

Property Description

The property is located in the popular West Fife village of High Valleyfield which is well placed for transport networks. The property is a spacious first floor flat in a purpose built block with ample residents parking to the front. There is double glazing, gas central heating and good storage facilities throughout. The accommodation comprises: entrance hall, large lounge, kitchen, 2 double bedrooms and bathroom. EPC Rating = Band C.

Our View

Excellent opportunity for a first time buyer or investor to acquire this spacious first floor flat in this popular coastal village location. Viewing is strongly recommended.

Location

The popular village of High Valleyfield offers a selection of local shops and amenities. The property is well placed for further local and high street shopping in Dunfermline town which also provides a selection of bars, restaurants, churches, primary and secondary schools along with numerous leisure facilities. The area is served by Queen Margaret and Dunfermline Railway Stations. For the commuter, the M90 and Kincardine Bridge are available.



Spacious Bright Upper Flat
For full EPC please contact the branch

Ground Floor

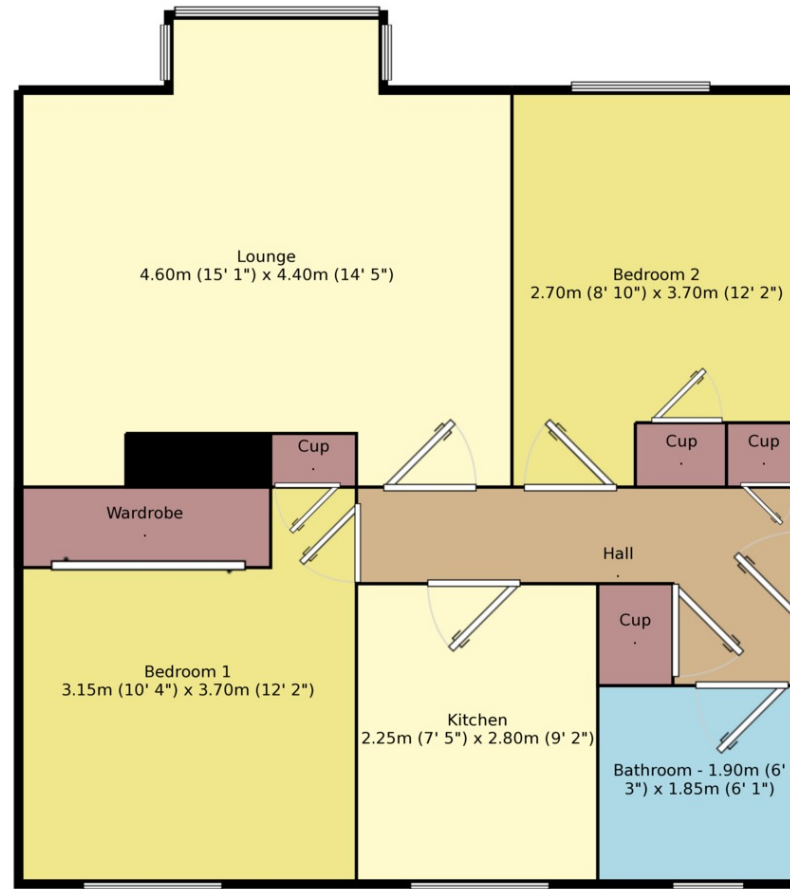

Measurements are approximate. Not to scale. For illustrative purposes only.

IMPORTANT NOTE TO PURCHASERS: We endeavour to make our sales particulars accurate and reliable, however, they do not constitute or form part of an offer or any contract and none is to be relied upon as statements of representation or fact. The services, systems and appliances listed in this specification have not been tested by us and no guarantee as to their operating ability or efficiency is given. All measurements have been taken as guide to prospective buyers only, and are not precise. Floor plans where included are not to scale and accuracy is not guaranteed. If you require clarification or further information on any points, please contact us, especially if you are travelling some distance to view. Fixtures and fittings other than those mentioned are to be agreed with the seller.

Your Move is a trading name of your-move.co.uk, registered in England at Newcastle House, Albany Court, Newcastle Business Park, Newcastle upon Tyne NE4 7YB (number 01864469).

11 New Row, Dunfermline, Fife, KY12 7EA
01383 739729 * dunfermline@your-move.co.uk

*Calls may be recorded and/or monitored for training and/or security purposes.

