

Gateway Street

Leicester

Offers In Region Of £75,000

0116 266 9977
www.seths.co.uk

Seths are delighted to offer this one bedroom studio apartment available solely to investors. The property is situated within the Primus Place complex just a short walk away from both De Montfort University and the Leicester City Centre.

Primus Place is a purpose built student accommodation scheme offering stylish and modern living, only available to post graduate students. The apartment is sold on a fully managed basis offering a hassle free addition to any property portfolio.

This first floor studio apartment comprises a spacious bedroom with fitted furnishings, including wall-mounted flat screen TV, built-in, walk-in cupboard, shower room, and kitchenette with fridge, microwave, hob, sink and cabinets. The unit has the use of communal laundry room and seating area.

LIVING AREA/BEDROOM
10' 6" x 10' 6" (3.2m x 3.2m)

KITCHEN
9' 1" x 5' 11" (2.77m x 1.8m)

SHOWER ROOM

Uppingham Office
265 Uppingham Road
Leicester
LE5 4DG

Opening Hours
Mon-Fri: 9am – 5:30pm
Sat: 10am - 1pm

LEASEHOLD INFORMATION

The property is currently let for £143.00 for a 51 week period.

Ground Rent £250.00
Service Charge £1456.23 (May Vary PA)
Length of lease 250 years from 2016

NB All of the figures quoted are to be verified by the purchasers solicitors.

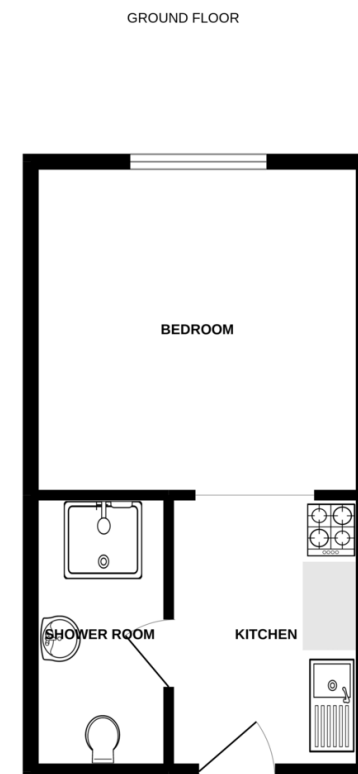
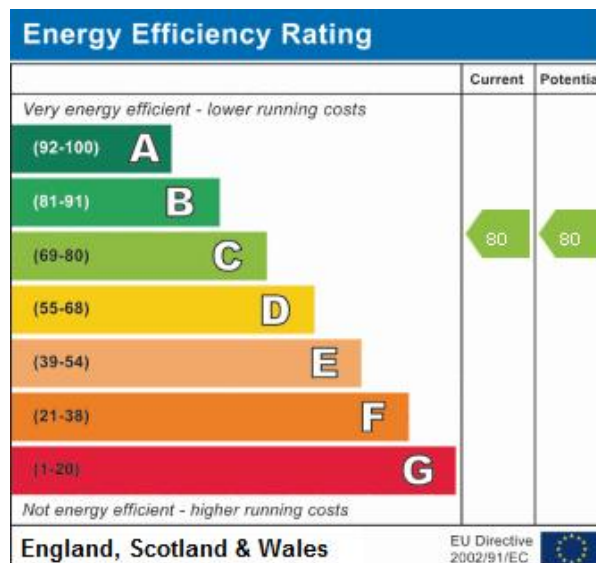

While every attempt has been made to ensure the accuracy of the floorplan contained here, measurements of doors, windows, doors and any other items are approximate and no responsibility is taken for any error, omission or mis-statement. This plan is for illustrative purposes only and should be used as such by any prospective purchaser. The services, systems and appliances shown have not been tested and no guarantee as to their operability or efficiency can be given. Made with Metrepro 10/2012

Important Notice: 1. These particulars are issued on the understanding that all negotiations are conducted through Seths Estate Agents. 2. The particulars do not constitute part or all of an offer or contract. 3. All descriptions, floor plans and dimensions contained herein are approximate and given in good faith, without any responsibility; any intending purchaser must not rely on them as statements or representations of fact but must satisfy themselves by inspection or otherwise as to the correctness of them. 4. Seths have not tested the appliances, services and specific fittings; any intending purchaser must satisfy himself by inspection, independent advice or otherwise. 5. No person in the employment of Seths has any authority to make or give any representation or warranty whatsoever in relation to this property. 6. All offers placed need to be qualified by Seths or one of their advisors before being passed onto the Vendors. Intending purchaser will be asked to produce proof of funds and identification documents in order to comply with the Money Laundering Regulations 2003.

