



Seymours



Parkhill Road  
Camberley, GU17 0NB  
£415,000

Arrange a viewing: 01276 534100

## Property Details

2 bedrooms

1 bath

EPC Rating C

892 sq ft

Blackwater

- Two bedrooms
- Spacious living room
- Conservatory
- Modern bathroom
- Low maintenance rear garden
- Driveway parking for several cars
- Garage
- Convenient for Blackwater local shops, amenities and railway station

Attractive countryside at Hawley Woods



A semi detached two bedroom bungalow which benefits from a spacious living room and a conservatory as well as a low maintenance rear garden, plenty of driveway parking and a garage to the side. The property is conveniently located for Blackwater and the local shops, amenities and railway station as well as attractive countryside close by and excellent road links.

01276 534100 / [james@seymours-blackwater.co.uk](mailto:james@seymours-blackwater.co.uk)

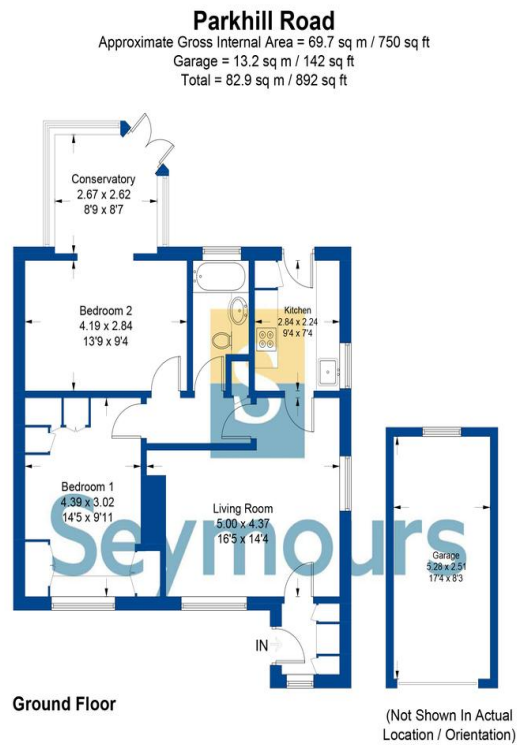

Illustration for identification purposes only, measurements are approximate, not to scale. FloorplansUsketch.com © 2023 (ID956893)