



Seymours



Hatherwood
Hampshire, GU46 6AJ
£425,000

Arrange a viewing: 01276 534100

Property Details

- 3 bedrooms
- 1 bath + 1 Cloakroom
- EPC Rating TBC
- 1036 sqft (inc garage)
- Blackwater (2.4 miles)

- Extended home
- Three bedrooms
- Cloakroom
- Living room
- Kitchen breakfast room
- Conservatory
- Solar Pannels
- Study area
- Storage space

A beautifully presented three-bedroom end terrace home which has been extended to provide a large modern kitchen breakfast room as well as a downstairs cloakroom, living room and a conservatory. There is also a modern bathroom. To the rear of the garage space is a useful study. The property also benefits from solar panels. To the side of the house is plenty of parking as well as a front driveway. The garage space is currently used as storage and a study area. To the rear of the house is a low maintenance garden. Hatherwood is well situated for Yateley and the good local schools, shops and amenities.

[01276 534100](tel:01276534100) / james@seymours-blackwater.co.uk



Hatherwood

Approximate Gross Internal Area = 84.3 sq m / 907 sq ft
Garage / Office = 12.0 sq m / 129 sq ft
Total = 96.3 sq m / 1036 sq ft

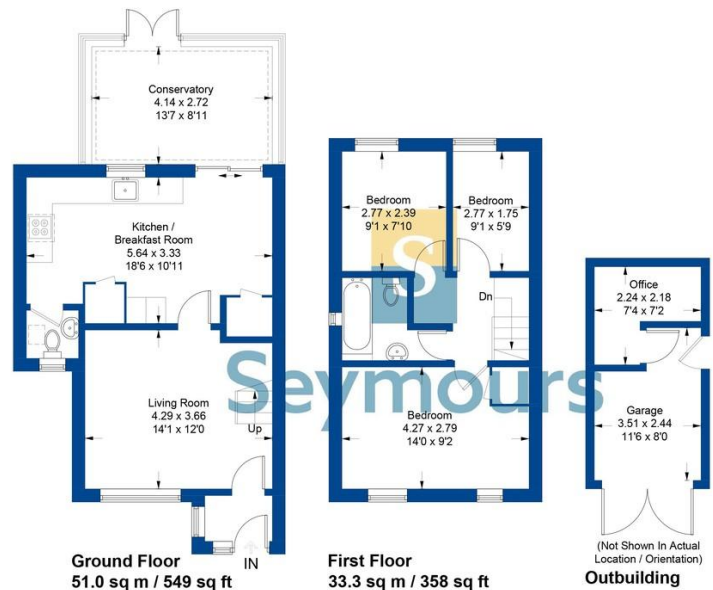

Illustration for identification purposes only, measurements are approximate, not to scale. FloorplansUsketch.com © 2024 (ID1042686)