

1 Bedroom Apartment **£120,000 OIRO**

2 Jagoda Court, Haydon End, Swindon, SN25 1TJ

mcfarlane
property.com

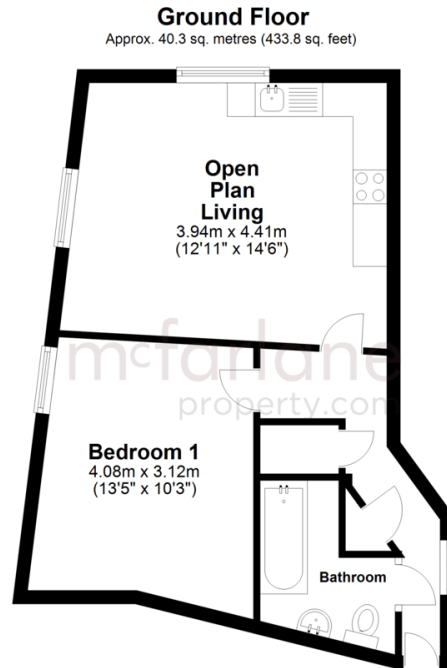

Total area: approx. 40.3 sq. metres (433.8 sq. feet)

- GROUND FLOOR APARTMENT
- ONE BEDROOM
- OPEN PLAN LIVING SPACE
- CARPORT

Positioned in the popular residential area of HAYDON END in North Swindon is this WELL PRESENTED one bedroom GROUND FLOOR APARTMENT that has the added benefit of an undercover ALLOCATED PARKING SPACE. In brief the accommodation comprises an OPEN PLAN LIVING AREA/KITCHEN, one good sized bedroom and bathroom. Located close to the amenities of ORBITAL RETAIL PARK, this would make the ideal purchase for someone looking to get onto the property ladder.
Service Charge £2460pa Lease Remaining 105years
Council Tax Band B

We 
where you
LIVE

Our team are friendly, experienced and are all local. They know it better than they do their own living rooms and can help you find what you're looking for because **we love where we live.**

We would be delighted to show you around this property.

**Because every home
needs a personal touch.**

**If you would like to view this
property then please get in touch.**

 01793 296600

 swindon@mcfarlaneproperty.com

mcfarlaneproperty.com

mcfarlane
property.com

Cricklade.
102 High Street
Cricklade SN6 6AA
 01793 751044

Marlborough.
106 High Street
Marlborough SN8 1LT
 01672 514380

Old Town.
28-30 Wood Street
Swindon SN1 4AB
 01793 296880

Swindon.
The Village Centre,
Redhouse SN25 2FW
 01793 296600

Agents Note: Whilst every care has been taken to prepare these sales particulars, they are for guidance purposes only. All measurements are approximate and are for general guidance purposes only and whilst every care has been taken to ensure their accuracy, they should not be relied upon and potential buyers are advised to recheck the measurements