

3F2 16 Eyre Place

NEW TOWN, EDINBURGH, EH3 5EP



Superb one-bedroom top-floor flat conveniently located in the heart of the New Town



0131 524 9797



www.mcewanfraserlegal.co.uk



info@mcewanfraserlegal.co.uk

McEwan Fraser Legal is delighted to present this superb one-bedroom top-floor flat conveniently located in the heart of the New Town, within easy walking distance of the excellent local amenities of cosmopolitan Stockbridge, the City Centre and King George Park.

THE LIVING ROOM



The property offers bright and beautifully presented contemporary accommodation, in good order throughout and benefits from a lovely open outlook to the front and many period features and a combination boiler.

THE KITCHEN



THE BEDROOM



THE BATHROOM



COMMUNAL STAIRS & VIEW



FLOOR PLAN, DIMENSIONS & MAP

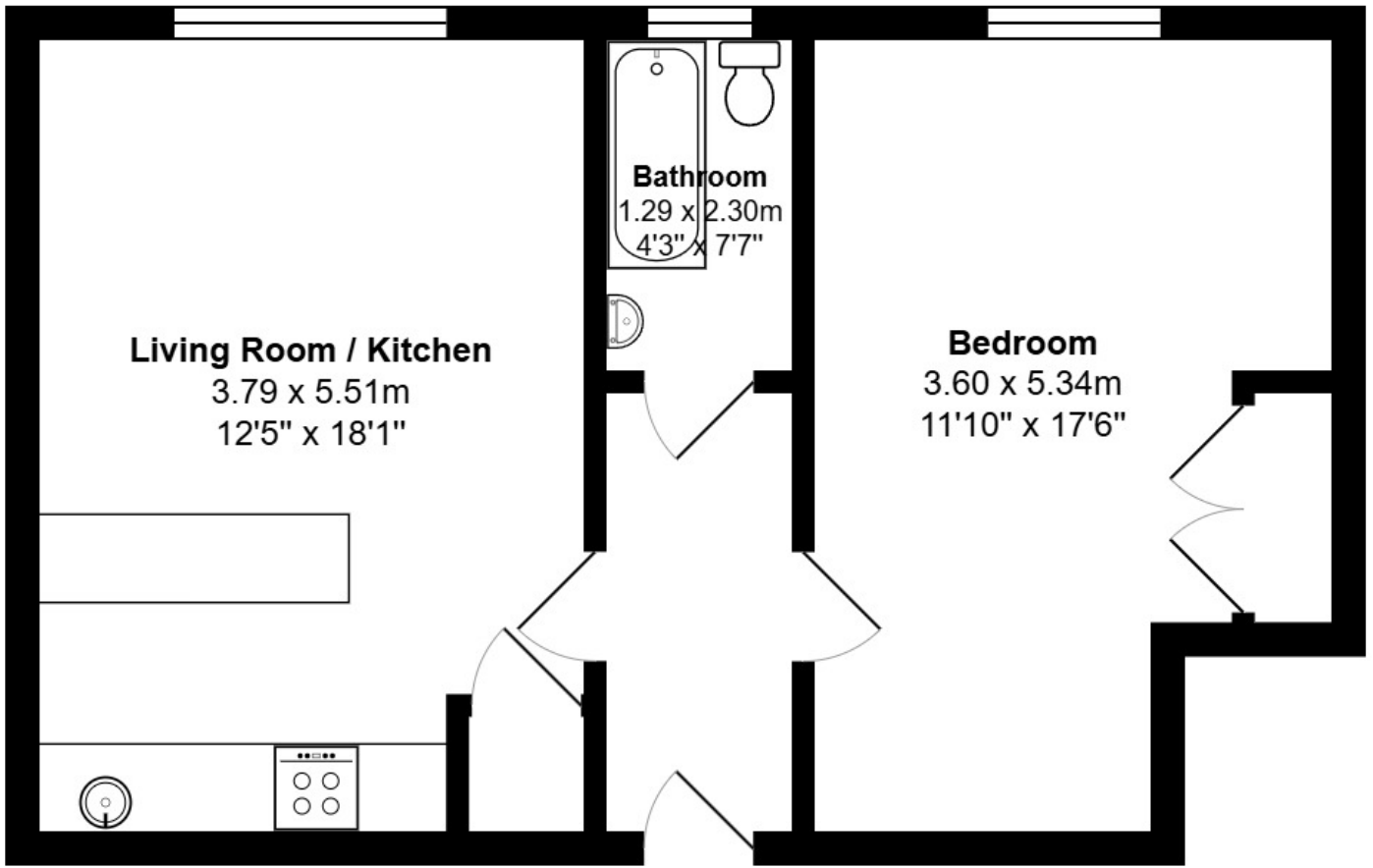

Approximate Dimensions (Taken from the widest point)

Gross internal floor area (m²): 48m² | EPC Rating: D

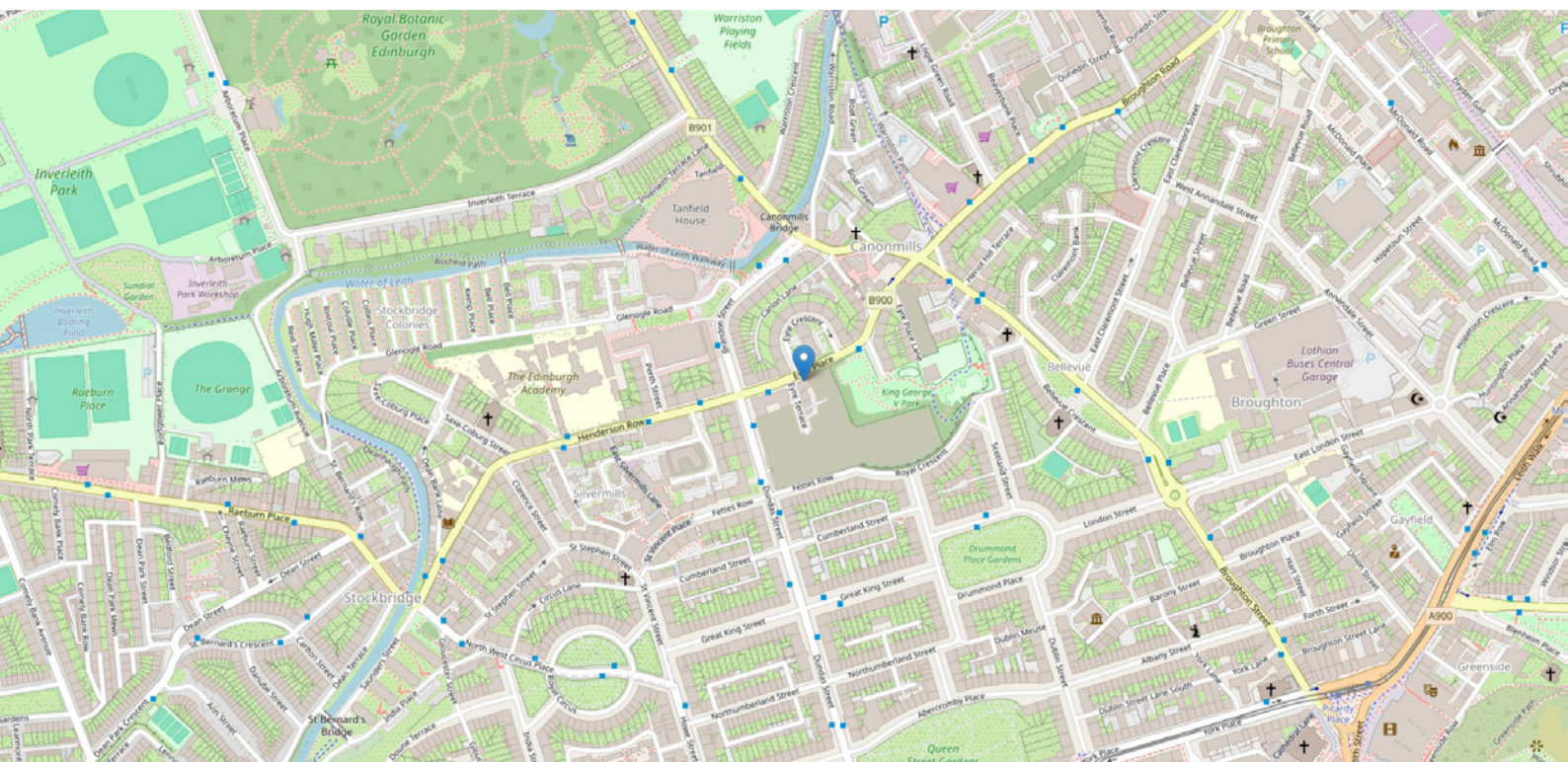

THE LOCATION

Canonmills is an extremely popular and sought-after area lying to the north of the city centre. Within the immediate vicinity, there is a wide range of local shopping, transport, recreational and educational facilities.





Local shopping can be found within the immediate vicinity for all your daily requirements but for those whose needs are great a Tesco's supermarket can be found on Broughton Road. For a greater range of specialised shopping, the city centre as previously mentioned is within walking distance.

The city centre is where Edinburgh's formal entertainment facilities are highly concentrated and here there are theatres, cinemas, many restaurants and bars, indoor sports facilities and health clubs.

Canonmills is within walking distance of the city centre although an excellent bus service runs minutes from the property and a five-minute bus journey will take you there.



McEwan Fraser Legal

Solicitors & Estate Agents

Tel. 0131 524 9797

www.mcewanfraserlegal.co.uk

info@mcewanfraserlegal.co.uk



Text and description
JAMIE MCINTOSH
Surveyor



Layout graphics and design
ALLY CLARK
Designer

Disclaimer: The copyright for all photographs, floorplans, graphics, written copy and images belongs to McEwan Fraser Legal and use by others or transfer to third parties is forbidden without our express consent in writing. Prospective purchasers are advised to have their interest noted through their solicitor as soon as possible in order that they may be informed in the event of an early closing date being set for the receipt of offers. These particulars do not form part of any offer and all statements and photographs contained herein are for illustrative purposes and are not guaranteed or warranted. Buyers must satisfy themselves for the accuracy and authenticity of the brochure and should always visit the property to satisfy themselves of the property's suitability and obtain in writing via their solicitor what's included with the property including any land. The dimensions provided may include, or exclude, recesses intrusions and fitted furniture. Any measurements provided are for guide purposes only and have been taken by electronic device at the widest point. Any reference to alterations to, or use of, any part of the property does not mean that any necessary planning, building regulations or other consent has been obtained. A buyer must find out by inspection or in other ways that all information is correct. None of the appliances/services stated or shown in this brochure have been tested by ourselves and none are warranted by our seller or MFL.