

# 4 Montgomery Terrace

Hove BN3 5AX

Asking Price Of £575,000

- POETS CORNER
- THREE BEDROOMS
- BATHROOM
- KITCHEN
- CONSERVATORY
- LIVING/DINING ROOM
- PATIO GARDEN
- NO ONWARD CHAIN

Whitlock and Heaps bring to market this modern Victorian style house situated in the favoured Poets Corner district of Hove. The house offers three-bedroom accommodation presented in good decorative order. To the ground floor is a south facing living/dining room and kitchen leading onto the conservatory and patio garden. Being neutrally decorated throughout and sold with no onward chain. Hove seafront and mainline station are within a short walk along with local shops, cafes and eateries.

ENTRANCE HALL

**KITCHEN** Incorporating stainless steel sink unit with drainer and mixer tap, adjacent laminate worksurface with cupboards and drawers under, matching eye level wall cupboards, inset four ring gas hob, eye level oven, appliance space, tiled splashback, opening to:

**SUN ROOM** Door to garden.

**LIVING/DINING ROOM** Sash bay window, two radiators, door to garden.

FIRST FLOOR

**LANDING** Hatch to loft space.

**BEDROOM 1** Sash bay window, radiator.

**BEDROOM 2** UPVC double glazed window, radiator.

**BEDROOM 3** UPVC double glazed window, radiator.

**BATHROOM** White suite comprising panelled bath with shower over, glazed shower screen, wash hand basin with drawer under, low level w.c, part tiled walls, tiled floor, heated ladder style towel rail, sash window.

OUTSIDE

REAR PATIO GARDEN

Freehold

Council Tax Band D (taken from [www.brighton-hove.gov.uk/council-tax](http://www.brighton-hove.gov.uk/council-tax)).

We advise that you check this information, we will not be held responsible if the council tax band differs when occupying the property.

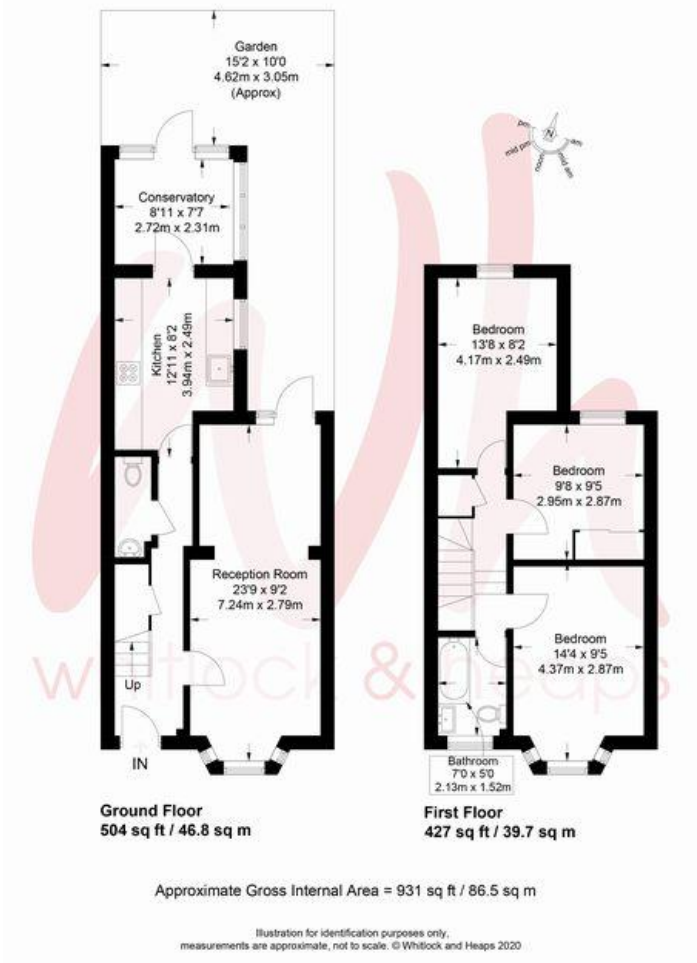

Score	Energy rating	Current	Potential
92+	A		
81-91	B		87 B
69-80	C	75 C	
55-68	D		
39-54	E		
21-38	F		
1-20	G		

Portslade Branch  
48 Boundary Road, Portslade BN3 4EF  
portslade@whitlockandheaps.co.uk  
01273 422706

Hove Branch  
65 Sackville Road, Hove BN3 3WE  
hove@whitlockandheaps.co.uk  
01273 778577



**Disclaimer:** Whitlock & Heaps have produced these particulars in good faith and they are set out as a general guide. Accuracy is not guaranteed, nor do they form part of any contract. If there is any particular aspect of these details which you require any confirmation, please do contact us, especially if contemplating a long journey. All measurements are approximate. Fixtures and fittings, other than those mentioned above, to be agreed with the seller. Any services, systems or appliances at the property have not been tested.