



## Parc Terrace, £140,000

- Ideal First Time Buyer Home
- Corner Plot
- Modern Throughout
- Enclosed Rear Garden
- Viewing Highly Recommended
- EPC Rating: C



2 1 1



## About the property

Situated on a generous corner plot, this beautifully presented two-bedroom end-terrace property offers contemporary living throughout and is ideally located close to Swansea City Centre, the M4 corridor, and with convenient access to Morriston Hospital.

The home features a spacious, modern kitchen with ample storage, making it perfect for both everyday living and entertaining. The light and airy living areas create a welcoming atmosphere, while the two generously sized bedrooms provide comfortable accommodation for couples, small families, or professional sharers.

A well-appointed family bathroom completes the upstairs layout, offering both style and practicality.

Externally, the property boasts a substantial corner plot garden, presenting fantastic potential for landscaping, outdoor entertaining, or even future extension (subject to planning).

This home is an ideal step onto the property ladder or a smart addition to any investment portfolio.



## Accommodation

### Entrance Hall

### Living Room

12' 4" Max x 12' 1" Max ( 3.76m Max x 3.68m Max )

### Kitchen

15' 4" x 8' 9" ( 4.67m x 2.67m )

### Landing

### Bedroom One

12' 4" Max x 12' 1" Max ( 3.76m Max x 3.68m Max )

### Bedroom Two

8' 9" Max x 8' 9" Max ( 2.67m Max x 2.67m Max )

### Bathroom

01792 798201

morrison@peteralan.co.uk

## Floorplan

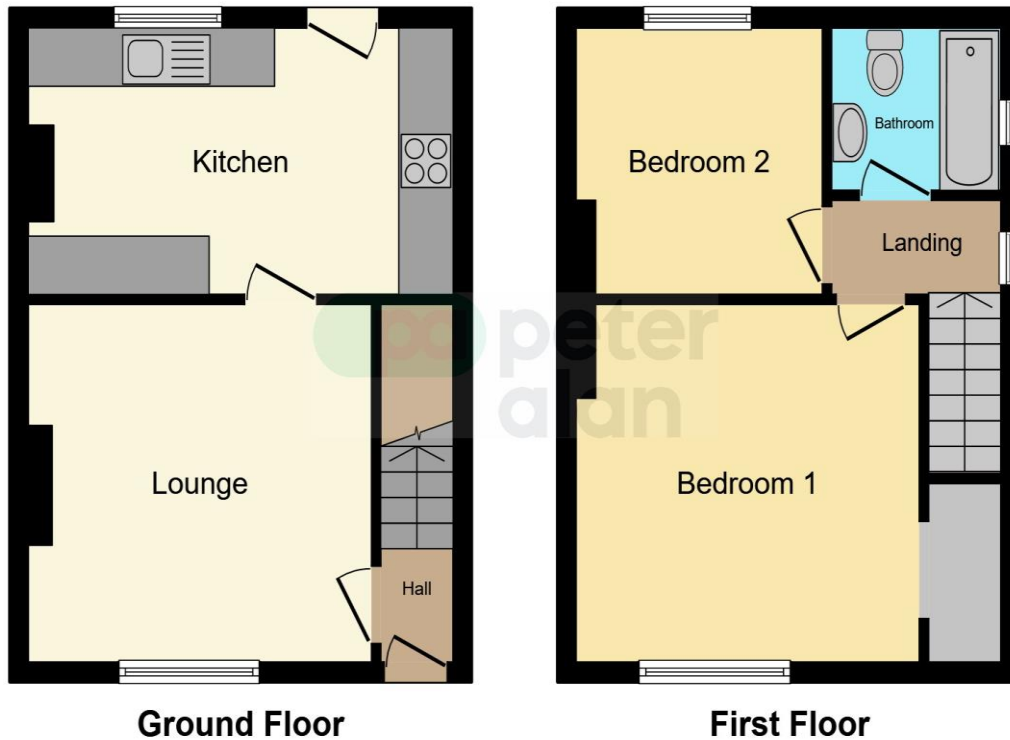

This floor plan is for illustrative purposes only. It is not drawn to scale. Any measurements, floor areas (including any total floor area), openings and orientation are approximate. No details are guaranteed, they cannot be relied upon for any purpose and they do not form part of any agreement. No liability is taken for any error, omission or misstatement. A party must rely upon its own inspection(s). Powered by [www.focalagent.com](http://www.focalagent.com)

## Important Information

Note while we endeavour to make our sales details accurate and reliable, if there is any point which is of particular interest to you, please contact the office and we will be pleased to confirm the position for you. We have not personally tested any apparatus, equipment, fixtures, fittings or services and cannot verify they are in working order or fit for their purposes. Nothing in these particulars is intended to indicate that carpets or curtains, furnishings or fittings, electrical goods (whether wired or not). Gas fires or light fittings or any other fixtures not expressly included form part of the property offered for sale. This computer generated Floorplan, if applicable, is intended as a general guide to the layout and design of the property. It is not to scale and should not be relied upon for dimensions. Tenure: We cannot confirm the tenure of the property as we have not had access to the legal documents. The buyer is advised to obtain verification from their solicitor or surveyor.

Peter Alan Limited is registered in England and Wales under company number 2073153, Registered Office is Cumbria House, 16-20 Hockliffe Street, Leighton Buzzard, Bedfordshire, LU7 1GN. VAT Registration Number is 500 2481 05. For activities relating to regulated mortgages and non-investment insurance contracts, Peter Alan Limited is an appointed representative of Connells Limited which is authorised and regulated by the Financial Conduct Authority. Connells Limited's Financial Services Register number is 302221. Most buy-to-let

**pa** peter  
alan