



## Heol Pantyrawel, £260,000

- Extended 3 bedroom Semi-Detached
- Immaculately Presented throughout
- Luxury Master with Ensuite
- Council Tax Band B
- Stunning Mountain Views
- EPC Rating: C



 3
  1
  2





## About the property

This stunning home has been completely transformed to an exceptional standard, offering generous and versatile living space in a sought-after semi-rural setting. Ideally located just half a mile from Blackmill village centre, you'll find local amenities including a post office, shop, petrol station, pubs, and access to the popular Celtic Trail cycle track all within easy reach. The M4 at Jct 36 is approximately 4 miles away, offering excellent commuter links.

Set in a slightly elevated position, the accommodation comprises a welcoming hallway, two spacious reception rooms, ground floor cloakroom, and a striking open plan kitchen/dining room with sleek contemporary finishes and direct access to the rear garden - ideal for modern family living and entertaining. There's also a separate laundry room for added convenience.

Upstairs features a generous landing leading to three large double bedrooms, a luxury four-piece family bathroom with freestanding slipper bath, and a showstopping master suite complete with its own ensuite shower room and private dressing room.

Externally, the property enjoys a landscaped front garden with open aspect, a level enclosed rear garden with two patio seating areas, and a block-paved double driveway to the rear. Further benefits include uPVC double glazing, gas combination boiler, multi-fuel burner.







## Accommodation

**Living Room** - 18' 9" x 11' 5" ( 5.71m x 3.48m )

**Lounge/Study** - 11' x 9' 9" ( 3.35m x 2.97m )

**Kitchen/Diner** - 16' 6" x 15' 2" ( 5.03m x 4.62m )

**Utility Room** - 10' 9" x 8' 2" ( 3.28m x 2.49m )

**Cloakroom**

**First Floor**

**Landing**

**Bedroom One** - 16' 7" x 15' 3" ( 5.05m x 4.65m )

**En Suite**

**Bedroom Two** - 12' 7" x 12' ( 3.84m x 3.66m )

**Bedroom Three** - 12' 7" x 11' 11" ( 3.84m x 3.63m )

**Bathroom**

01656 657201

bridgend@peteralan.co.uk

## Floorplan



**Ground Floor**

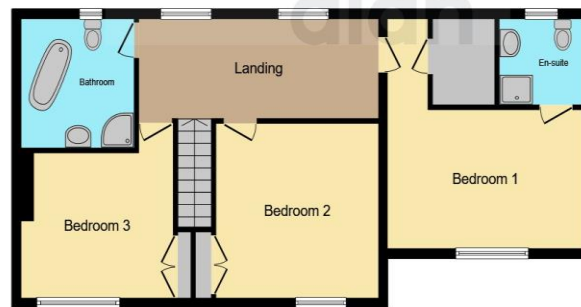

**First Floor**

This floor plan is for illustrative purposes only. It is not drawn to scale. Any measurements, floor areas (including any total floor area), openings and orientation are approximate. No details are guaranteed, they cannot be relied upon for any purpose and they do not form part of any agreement. No liability is taken for any error, omission or misstatement. A party must rely upon its own inspection(s). Powered by [www.focalagent.com](http://www.focalagent.com)

## Important Information

Note while we endeavour to make our sales details accurate and reliable, if there is any point which is of particular interest to you, please contact the office and we will be pleased to confirm the position for you. We have not personally tested any apparatus, equipment, fixtures, fittings or services and cannot verify they are in working order or fit for their purposes. Nothing in these particulars is intended to indicate that carpets or curtains, furnishings or fittings, electrical goods (whether wired or not). Gas fires or light fittings or any other fixtures not expressly included form part of the property offered for sale. This computer generated Floorplan, if applicable, is intended as a general guide to the layout and design of the property. It is not to scale and should not be relied upon for dimensions. Tenure: We cannot confirm the tenure of the property as we have not had access to the legal documents. The buyer is advised to obtain verification from their solicitor or surveyor.

Peter Alan Limited is registered in England and Wales under company number 2073153, Registered Office is Cumbria House, 16-20 Hockliffe Street, Leighton Buzzard, Bedfordshire, LU7 1GN. VAT Registration Number is 500 2481 05. For activities relating to regulated mortgages and non-investment insurance contracts, Peter Alan Limited is an appointed representative of Connells Limited which is authorised and regulated by the Financial Conduct Authority. Connells Limited's Financial Services Register number is 302221. Most buy-to-let