



St. Donatts Road, London

**Offers Over £300,000**

### Property Description

We are pleased to offer for sale this one bedroom first floor period style flat forming part of this period style house in New Cross. Comprising of entrance with entrance hallway, lounge/diner, kitchen, bathroom/WC, gas central heating and double glazing where stated. No chain involved, viewing is highly recommended. A copy of the epc will be available on request. EPC Grade F.



## Our View

A fantastic investment opportunity as Goldsmiths College is close by. This flat forms part of a period style property and viewing is highly recommended.

## Location

Close to Goldsmith's College in New Cross, New Cross British rail station and Lewisham town centre. The property is situated next to similar period style properties in the same road close to Deptford, New Cross and Lewisham.

St Donatts Road,

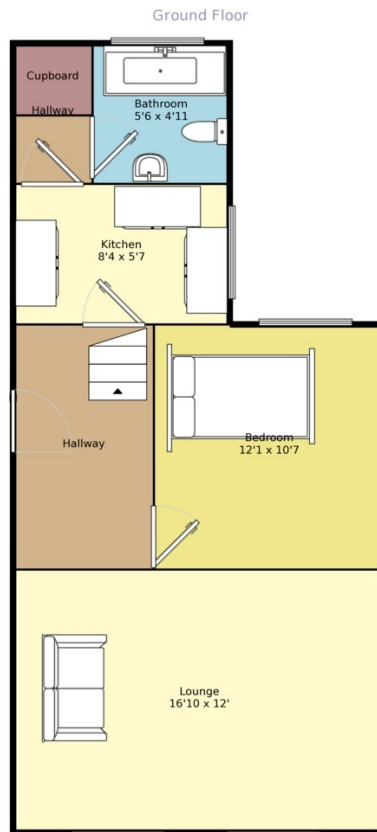

Measurements are approximate. Not to scale. For illustrative purposes only.



### One Bedroom First Floor Flat For full EPC please contact the branch

**IMPORTANT NOTE TO PURCHASERS:** We endeavour to make our sales particulars accurate and reliable, however, they do not constitute or form part of an offer or any contract and none is to be relied upon as statements of representation or fact. The services, systems and appliances listed in this specification have not been tested by us and no guarantee as to their operating ability or efficiency is given. All measurements have been taken as guide to prospective buyers only, and are not precise. Floor plans where included are not to scale and accuracy is not guaranteed. If you require clarification or further information on any points, please contact us, especially if you are travelling some distance to view. Fixtures and fittings other than those mentioned are to be agreed with the seller.

Your Move is a trading name of your-move.co.uk, registered in England at Newcastle House, Albany Court, Newcastle Business Park, Newcastle upon Tyne NE4 7YB (number 01864469).

\*Calls may be recorded and/or monitored for training and/or security purposes.

Your Move, 163 New Cross Road, New Cross,  
London, SE14 5DG

020 7 639 1103 \* [newcross@your-move.co.uk](mailto:newcross@your-move.co.uk)

