

Agents Note: Whilst every care has been taken to prepare these sales particulars, they are for guidance purposes only. All measurements are approximate and for general guidance purposes only and whilst every care has been taken to ensure their accuracy, they should not be relied upon and potential buyers are advised to check the measurements

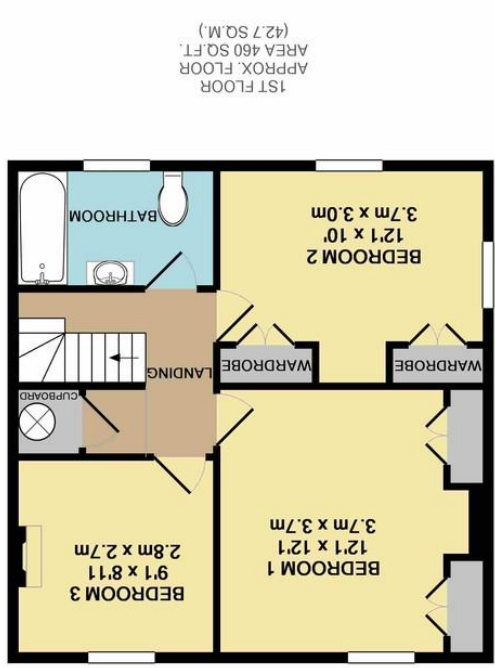

ALMA COTTAGE, BEECH ROAD, BOX HILL, CORSHAM, SN13 8EU
TOTAL APPROX. FLOOR AREA 1048 SQ.FT. (97.3 SQ.M.)
Schematic Diagram only - Not to scale
Made with Metropix ©2017



Alma Cottage, Box Hill, Corsham, Wiltshire, SN13 8EU

Alma Cottage, Box Hill, Corsham, Wiltshire, SN13 8EU

- Three bedroom, two reception rooms
- Lawned gardens to the front, side and rear
- Widespread views to the front
- Conservatory
- Off street parking
- NO ONWARD CHAIN

£385,000

Situation and Description

An attractive period property which enjoys an elevated position with fabulous views to the front over the Hazelbury valley.

The property offers accommodation comprising entrance hall, cloakroom, sitting room with feature fireplace and wood burning stove, dining room, conservatory, kitchen, three bedrooms and a bathroom.

Externally there are mature gardens to the front, side and rear and off street parking.

Sitting in a most private position in the hills above Box on the Southernmost outcrop of the Cotswolds, in an area of outstanding natural beauty, this charming property enjoys a breathtaking setting. Alma Cotage lies on the edge of the sought after village of Box with its Ofsted rated outstanding Primary school, shops and public houses.

EPC Rating - E



Directions

Leave Corsham on the A4 towards Box. Turn left onto Beech Road and follow the road down to the bottom where the property can be found on the right hand bend just before you return onto the A4.