



CELEBRATING
15 YEARS
of successfully selling homes



propertyladder 



propertyladder 



propertyladder 



propertyladder 

Harvest Close, Hainford, NR10 3TA

An extended Detached House with Four Bedrooms, two Ensuites and a study

£390,000

Harvest Close, Hainford, NR10 3TA

An extended Detached House with Four Bedrooms, two Ensuities and a study

Overview

- Detached House
- Four Bedrooms
- Two Ensuities
- Conservatory
- Study
- Open Plan Kitchen
- Enclosed Rear Garden
- Popular Village Location
- Must Be Seen!



“This gorgeous village home has been extended and improved to create a fantastic family home!”



FANTASTIC FAMILY SIZED HOME!

Extended and improved by the current owners, this detached house offers all the space you could need. With four bedrooms, two of which have ensuite facilities, a gorgeous open plan kitchen, a study and a conservatory, there is plenty of room here to spread out!



Location

Hainford is conveniently located approximately 9 miles north of Norwich with good access via the A140 Cromer Road to the city, Aylsham and also the North Norfolk coastal area. Local amenities include a primary school and the Chequers public house which is also on Stratton Road. A much wider range of shops and amenities can be found in the market town of Aylsham and the city of Norwich.



Directions

Leave Norwich via the A140 Cromer Road, continuing past the turning to Horsham St Faith and take the next turning on the right to Newton St Faith. At the T-junction turn left and then follow the road round to the right into Newton Street. Follow Newton Street through the village where the road leads into Newton Road towards Hainford. Continue past Lady Lane on the right and take the next turning on the right into Chapel Road. Harvest Close can be found on the left.

GROUND FLOOR
823 sq.ft. (76.4 sq.m.) approx.

1ST FLOOR
666 sq.ft. (61.9 sq.m.) approx.

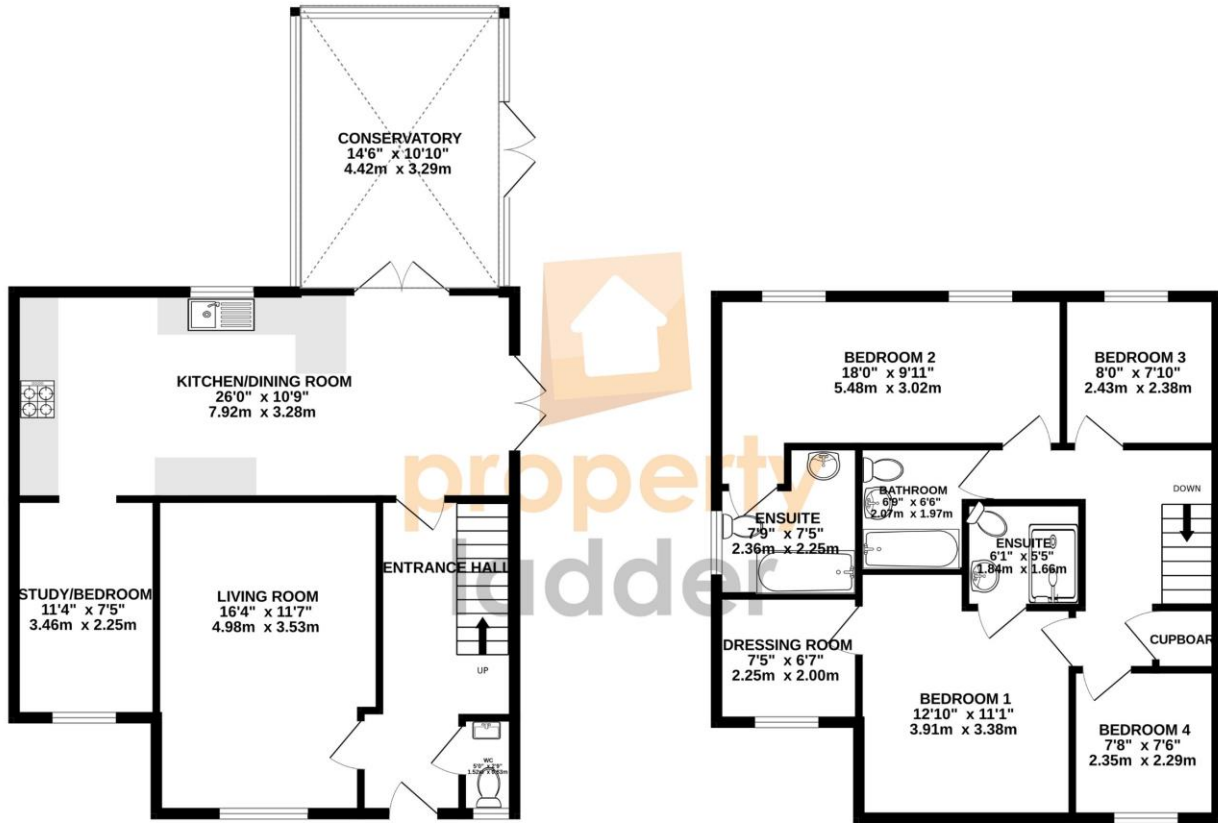

FULL EPC AVAILABLE UPON REQUEST

TOTAL FLOOR AREA : 1489 sq.ft. (138.4 sq.m.) approx.

Whilst every attempt has been made to ensure the accuracy of the floorplan contained here, measurements of doors, windows, rooms and any other items are approximate and no responsibility is taken for any error, omission or mis-statement. This plan is for illustrative purposes only and should be used as such by any purchaser. The services, systems and appliances shown have not been tested and no guarantee as to their operability or efficiency can be given.
Made with Metropix 6/2023

Score	Energy rating	Current	Potential
92+	A		97 A
81-91	B		
69-80	C		
55-68	D	61 D	
39-54	E		
21-38	F		
1-20	G		



Selling your home?

If you are considering selling your home please contact us for your no obligation free market appraisal.

Get in touch today!
Tel: 01603 898100

CELEBRATING 15 YEARS
of successfully selling homes

f 98 Crostwick Lane, Spixworth, NR10 3NQ
T 01603 898100
propertyladderonline.com

i

IMPORTANT NOTICE: Property Ladder, their clients and any joint agents give notice that: 1. They are not authorised to make or give any representations or warranties in relation to the property either here or elsewhere, either on their own behalf or on behalf of their client or otherwise. They assume no responsibility for any statement that may be made in these particulars. These particulars do not form part of any offer or contract and must not be relied upon as statements or representations of fact. 2. Any areas, measurements or distances are approximate. The text, photographs and plans are for guidance only and are not necessarily comprehensive. It should not be assumed that the property has all necessary planning, building regulation or other consents and Property Ladder have not tested any services, equipment or facilities. Purchasers must satisfy themselves by inspection or otherwise.