



MILE



Felixstowe Road, London NW10 OIEO £350,000 Share of Freehold

Well positioned top floor apartment in Kensal Green flooded with natural light. Set on the top floor of this quaint conversion, this apartment offers superb and secure living space across 483 sq ft. Loved and nurtured by the current owner, this apartment benefits from a 10ft double bedroom with built in storage, a generous three piece bathroom, and a great 15ft open plan kitchen living area. Full of charm, the property also benefits from a wealth of natural light. Sold with a share of the freehold and potentially chain free. Felixstowe Road is located moments away from Kensal Green (Bakerloo Line & Overground) station and also within easy walking distance from Kensal Rise (Overland) and the trendy coffee shops, bars, gastro pubs, restaurants and numerous bus routes

- Top floor apartment
- One bedroom
- Share of Freehold
- Open plan kitchen living area
- Can be chain free
- Fantastic location
- Great condition
- Walking distance from open green spaces of NW10
- Quiet residential road
- Close to shops and transport

Felixstowe Road NW10 5SR

Approx Gross Internal Area = 44.9 sq m / 483 sq ft

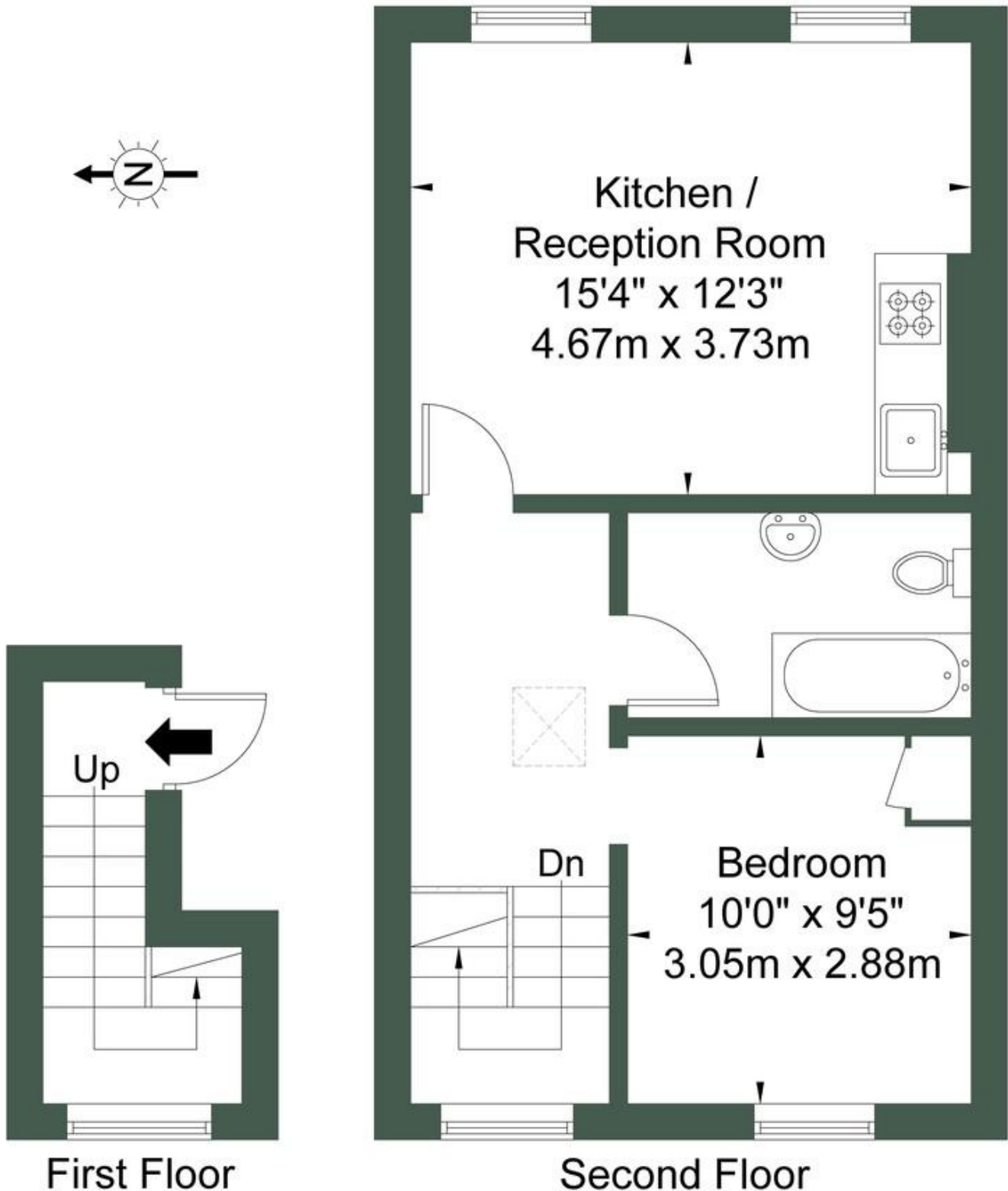

First Floor

Second Floor

Ref

Copyright

M MILE

The Floor plan is not to scale and measurements and areas shown are approximate and therefore should be used for illustrative purposes only. The plan has been prepared in accordance with the RICS code of Measuring Practice and whilst we have confidence in the information produced it must not be relied on. If there is any aspect of particular importance, you should

MONEY LAUNDERING REGULATIONS 2003: Intending purchasers will be asked to produce identification documentation at a later stage and we would ask for your co-operation in order that there will be no delay in agreeing the sale.

General: While we endeavour to make our sales particulars fair, accurate and reliable, they are only a general guide to the property and, accordingly, if there is any point which is of particular importance to you, please contact the office and we will be pleased to check the position for you, especially if you are contemplating travelling some distance to view the property.

Measurements: These approximate room sizes are only intended as general guidance. You must verify the dimensions carefully before ordering carpets or any built-in furniture.

Services: Please note we have not tested the services or any of the equipment or appliances in this property, accordingly we strongly advise prospective buyers to commission their own survey or service reports before finalising their offer to purchase.