



WOODLANDS PARK, TEDBURN ST. MARY
GUIDE PRICE - £160,000



**** NO CHAIN **** A well-presented and well looked after Park home situated on a private plot at Woodlands Park. This home is very spacious with a large bright and airy lounge, an open dining space, two large double bedrooms along with an office / spare room, practical kitchen, a bathroom, a front portch and and an easy to maintain wrap around garden.

Situated approximately 6 miles from the Cathedral city of Exeter. The site is exclusively for the retired or semi retired. (over 50's) Just along the road you will find Fingle Glen Golf Course and Pathfinder village which offers a wide range of amenities including post office, shop, hairdressers, church and social club

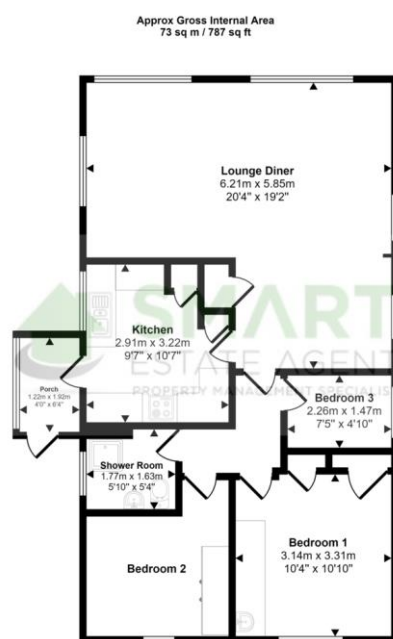

Floorplan

This floorplan is only for illustrative purposes and is not to scale. Measurements of rooms, doors, windows, and any items are approximate and no responsibility is taken for any error, omission or mis-statement. Icons of items such as bathroom suites are representations only and may not look like the real items. Made with Made Snappy 360.

10 Southernhay West,
Exeter, Devon, EX1 1JG

www.smartestateagent.co.uk
exeter@smartestateagent.co.uk
uk

Agents Note: Whilst every care has been taken to prepare these sales particulars, they are for guidance purposes only. All measurements are approximate are for general guidance purposes only and whilst every care has been taken to ensure their accuracy, they should not be relied upon and potential buyers are advised to recheck the measurements.