



FOR SALE

3 Bed Semi-Detached House in Heatherley Grove, Wigston LE18 2EX
£250,000

Located in the ever popular development of Heatherley Grove in Wigston sits this modern three bedroom semi detached set on an attractive plot. The accommodation comprises of main entrance hall, lounge and dining area, fitted kitchen, ground floor WC, landing to three bedrooms, master with en-suite shower room, family bathroom, landscaped gardens, ample off road parking. Call Phillips George to view.



GROUND FLOOR
375 sq.ft. (34.8 sq.m.) approx.

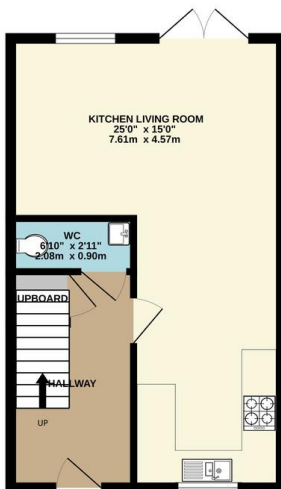

1ST FLOOR
375 sq.ft. (34.8 sq.m.) approx.

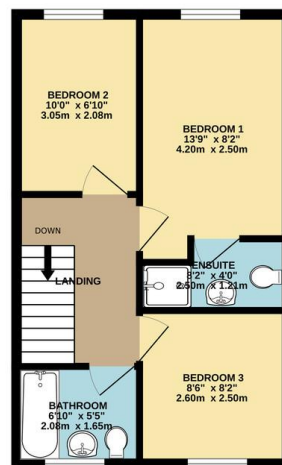

TOTAL FLOOR AREA : 749 sq.ft. (69.6 sq.m.) approx.

Whilst every attempt has been made to ensure the accuracy of the floorplan contained here, measurements of doors, windows, rooms and any other items are approximate and no responsibility is taken for any error, omission or mis-statement. This plan is for illustrative purposes only and should be used as such by any prospective purchaser. The finishes, fixtures and appliances shown have not been tested and no guarantee as to their operability or efficiency can be given.
Made with Metropac (2024).

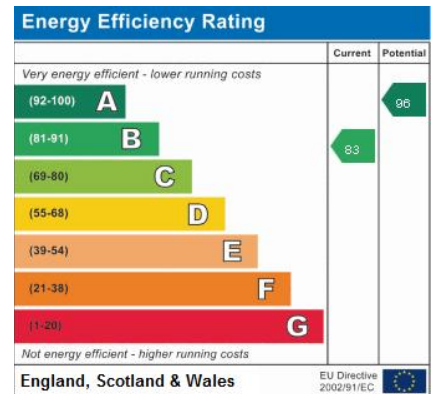

- Semi Detached
- Three Bedrooms
- Popular Location
- Master Ensuite
- Ground Floor W.C
- Landscaped Gardens
- Off Road Parking
- NHBC

Agents Note: Whilst every care has been taken to prepare these sales particulars, they are for guidance purposes only. All measurements are approximate are for general guidance purposes only and whilst every care has been taken to ensure their accuracy, they should not be relied upon and potential buyers are advised to recheck the measurements.

