



2 Bedroom Coach House £180,000

Deneb Drive, Oakhurst, Swindon, Wiltshire, SN25 2LG

**mcfarlane**  
property.com

We   
where you  
**LIVE**

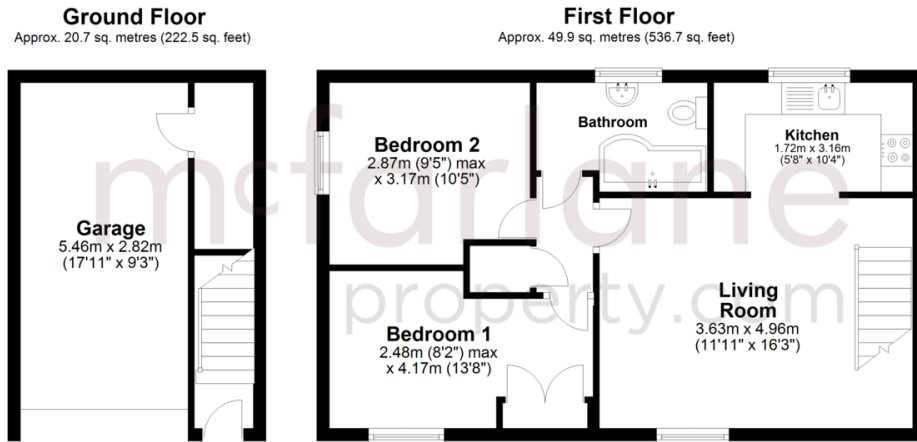

Total area: approx. 70.5 sq. metres (759.2 sq. feet)

- NO ONWARD CHAIN
- LARGE SEMI DETACHED COACH HOUSE
- TWO DOUBLE BEDROOMS
- LARGE GARAGE AND OFF ROAD PARKING
- FAMILY BATHROOM
- LONG LEASE 980 YEARS
- LOW SERVICE CHARGES
- QUIET LOCATION IN POPULAR OAKHURST
- IDEAL FIRST TIME OR INVESTMENT PURCHASE

Our team are friendly, experienced and are all local. They know it better than they do their own living rooms and can help you find what you're looking for because **we love where we live.**

We would be delighted to show you around this property.

**Because every home  
needs a personal touch.**

**If you would like to view this  
property then please get in touch.**

📞 01793 296600

✉ swindon@mcfarlaneproperty.com

[mcfarlaneproperty.com](http://mcfarlaneproperty.com)

\*\*\* NO ONWARD CHAIN \*\*\*This large SEMI DETACHED Coach House, with TWO DOUBLE BEDROOMS, family bathroom, with LARGE GARAGE with access to the under stairs storage and parking in front. It is available with NO ONWARD CHAIN and benefits from a LONG LEASE and LOW SERVICE CHARGES an ideal first time or investment purchase.

Council Tax Band C - Estimated cost £1954 p.a.  
Remaining Lease 980 years  
Service Charge £492 p.a.  
Ground Rent £205 p.a.

**mcfarlane**  
property.com

**Cricklade.**  
102 High Street  
Cricklade SN6 6AA  
📞 01793 751044

**Marlborough.**  
106 High Street  
Marlborough SN8 1LT  
📞 01672 514380

**Old Town.**  
28-30 Wood Street  
Swindon SN1 4AB  
📞 01793 296880

**Swindon.**  
The Village Centre,  
Redhouse SN25 2FW  
📞 01793 296600

Agents Note: Whilst every care has been taken to prepare these sales particulars, they are for guidance purposes only. All measurements are approximate are for general guidance purposes only and whilst every care has been taken to ensure their accuracy, they should not be relied upon and potential buyers are advised to recheck the measurements