



10 Steggall Close | Needham Market | Suffolk | IP6 8EB

Specialist marketing for | Barns | Cottages | Period Properties | Executive Homes | Town Houses | Village Homes

TOWN & VILLAGE
PROPERTIES

To find out more or arrange a viewing please contact 01449 722003 or visit www.townandvillageproperties.co.uk

10 Steggall Close, Needham Market, Ipswich, Suffolk IP6 8EB

“A superb opportunity to acquire this extended three-bedroom semi-detached property benefiting from single garage, off-road parking & proportionate gardens”

Description

A spacious and extended, three bedroom, semi-detached house located in a tucked away position on a no through road just a stone's throw from Needham Market town centre with its wide range of amenities.

The accommodation comprises: entrance hall, sitting room, dining room, kitchen, first floor landing, three bedrooms and shower/wet room.

Notable benefits include a single garage as well as ample off-road parking and proportionate, predominantly lawned rear gardens.

About the Area

Needham Market is a desirable small town situated in the heart of Mid Suffolk between the towns of Bury St Edmunds and Ipswich. There are a range of everyday amenities and individual shops including butcher, baker, tea shops/cafes, public houses, take-away restaurants, a post office and a Co-op supermarket. There is also a library, community centre, dentist and a good local primary school. Alder Carr Farm offers fresh farm food for sale and a restaurant.

Needham Market also has good transport links with bus and train services into Stowmarket and Ipswich, where there are mainline services to London Liverpool Street Station. A range of events are held throughout the year, including street fairs and raft racing at Needham Lake which is a Conservation Area with a number of countryside walks.

The nearby towns of Stowmarket, Bury St Edmunds and Ipswich provide further amenities, recreational and cultural facilities and a range of individual high street stores.

The accommodation in more detail comprises:

Front door to:

Entrance Hall

Windows to front aspect and door to:

Sitting Room Approx 17'5 x 12'10 (5.3m x 3.0m)

Generous, light and airy space, stairs rising to the first floor, dado rail and feature inset with wooden mantle surround. Opening to:

Dining Room Approx 12'10 x 8'10 (3.9m x 2.7m)

Currently set up as utility area with disabled access but equally as suitable as dining room as was originally designed and benefiting from dado rail. Archway to:



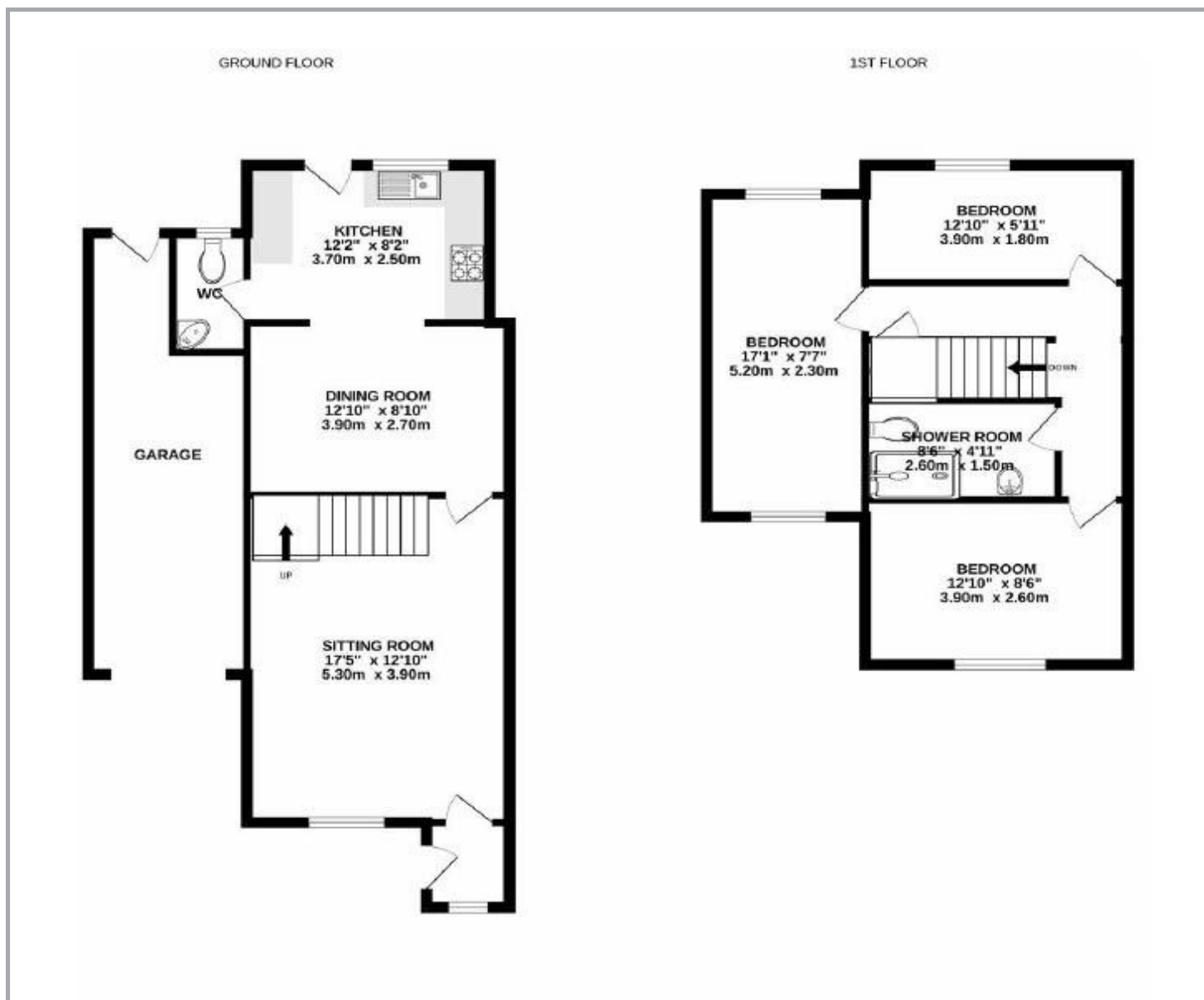

Kitchen Approx 12'2 x 8'2 (3.7m x 2.5m)

Fitted with a matching range of wall and base units and worktops over and inset one and a half bowl sink, drainer and chrome mixer tap. Integrated appliances include four ring gas hob with extractor and oven and grill.

Window to rear aspect, personnel door to rear, tiled flooring, space for washing machine. Door to:

Cloakroom

White suite comprising w.c, hand wash basin, tiled flooring, frosted window to rear aspect.

First Floor Landing

With access to loft and doors to:

Bedroom Two Approx 12'10 x 8'6 (3.9m x 2.6m)

Double room with windows to front aspect

Shower / Wet Room

White suite comprising w.c, hand wash basin, heated towel rail, shower attachment with shower drain, extractor and tiled walls.

Landing/ Inner hall

Door to airing cupboard housing hot water cylinder, incorporating shelving and door to:

Master Bedroom Approx 17'10 x 7'7 (5.2m x 2.3m)

A more recent addition to the property having been extended over the garage, now offering a substantial master bedroom suite with double aspect windows to the front and rear.

Bedroom Three 12'10 x 5'11 (5.20m x 1.8m)

Currently serving as the space for disabled access from the ground floor but able to be turned back to a double bedroom with window to rear aspect.

Outside

The property is located in a tucked way position within the cul de sac and is accessed over a private drive providing ample off-road parking as well as giving access to the single garage with up and over door, power and light connected.

To the rear are proportionate and predominantly lawned rear gardens with boundaries defined by fencing for the most part and incorporating a sun terrace towards the foot of the garden.

Local Authority

Mid Suffolk District Council

Council Tax Band – B

Services

Mains water, drainage and electricity. Gas-fired heating.

Disclaimer

Town & Village Properties (and its subsidiaries and their joint Agents where applicable) for themselves and for the vendors or lessors of this property for whom they act, give notice that (I) these particulars are a general outline only for the guidance of prospective purchasers or tenants, and do not constitute the whole or any part of an offer or contract (II) Town & Village Properties cannot guarantee the accuracy of any description, dimensions, references to conditions, necessary permissions for use and occupancy and other details contained herein and prospective purchasers or tenants must not rely on them as statements of fact or representations and must satisfy themselves as to their accuracy, (III) No employee of Town & Village Properties (and its subsidiaries and their joint Agents where applicable) has any authority to make or give any representation or warranty or enter into any contract whatever in relation to the property, (IV) Town & Village Properties (and its subsidiaries and their joint Agents where applicable) will not be liable in negligence or otherwise, for any loss arising from the use of these particulars and Town & Village Properties (and its subsidiaries and their joint Agents where applicable) have not tested any apparatus, equipment, fixtures and fittings or services and so cannot verify that they are in working order or fit for the purpose. A buyer is advised to obtain verification from their Solicitor, (V) Photographs will only show certain parts of the property and assumptions should not be made in respect of those parts of the property that have not been photographed. (Items or contents shown in the photographs are not included as part of the sale unless specified otherwise. It should not be assumed the property will remain as shown in the photograph. Photographs are taken using a wide-angle lens.

**Energy performance certificate (EPC)**

10, Steggall Close Needham Market IPSWICH IP6 8EB	Energy rating D	Valid until: 5 August 2025
		Certificate number: 8465-7928-3300-1785-8902

Property type	Semi-detached house
Total floor area	90 square metres

Rules on letting this property

Properties can be let if they have an energy rating from A to E.

You can read [guidance for landlords on the regulations and exemptions](https://www.gov.uk/guidance/domestic-private-rented-property-minimum-energy-efficiency-standard-landlord-guidance) (<https://www.gov.uk/guidance/domestic-private-rented-property-minimum-energy-efficiency-standard-landlord-guidance>).

Energy rating and score

This property's energy rating is D. It has the potential to be B.

See [how to improve this property's energy efficiency](#).

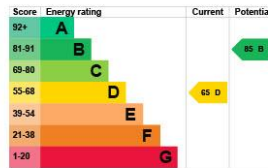

The graph shows this property's current and potential energy rating.

Properties get a rating from A (best) to G (worst) and a score. The better the rating and score, the lower your energy bills are likely to be.

For properties in England and Wales:

the average energy rating is D
the average energy score is 60

<https://find-energy-certificate.service.gov.uk/energy-certificate/8465-7928-3300-1785-8902?print=true>

1/4



Registered address:
Grove House
87a High Street
Needham Market
Suffolk
IP6 8DQ

Needham Market: info@townandvillageproperties.co.uk
Boxford: boxford@townandvillageproperties.co.uk

Boxford
2a Broad Street, Boxford, Suffolk, CO10 5DX
01787 704200

Needham Market
87a High Street, Needham Market, Suffolk, IP6 8DQ
01449 722003

London
121 Park Lane, London, W1K 7AG
020 7409 8403