



- Two Bedroom
- Allocated Parking
- Balcony
- Good Size

## Lambs Walk, Whitstable, Kent

£190,000 Leasehold

Great FTB or Investment opportunity – A light and spacious two bedroom first floor apartment located in a good residential area and offers good access to Whitstable town centre, bus routes into Whitstable and Canterbury Centres, with good, fast road links to London and the Kent Coast. The home itself is in good order throughout and benefits from generous size living accommodation comprises of hallway, lounge/diner, kitchen, two large bedrooms and a bathroom. Outside there is an allocated parking space and a balcony. This property is a must be see so call today on 01227 266 644



## Property Description

Great FTB or Investment opportunity – A light and spacious two bedroom first floor apartment located in a good residential area and offers good access to Whitstable town centre, bus routes into Whitstable and Canterbury Centres, with good, fast road links to London and the Kent Coast. The home itself is in good order throughout and benefits from generous size living accommodation comprises of hallway, lounge/diner, kitchen, two large bedrooms and a bathroom. Outside there is an allocated parking space and a balcony. This property is a must be see so call today on 01227 266 644

### ENTRANCE

Via stairway to first floor, then double glazed door into:

### HALLWAY

Loft hatch, radiator, storage cupboard housing boiler

### LOUNGE

18' 1" x 10' (5.51m x 3.05m) Double glazed sliding doors to the balcony, double glazed window to the front, two radiators, telephone point, open space to:

### KITCHEN

9' x 8' (2.74m x 2.44m) Double glazed window to the rear, matching wall and base units with work top, stainless steel drainer unit, space for fridge freezer, built in oven with electric hob and extractor fan above

### BEDROOM ONE

14' x 10' (4.27m x 3.05m) Double glazed window to the front, radiator, television point

### BEDROOM TWO

11' x 8' (3.35m x 2.44m) Double glazed window to the rear, radiator

### BATHROOM







Three piece suite comprising of a low level WC, pedestal wash hand basin, panelled bath with mixer tap, separate shower system above, double glazed window to the rear, radiator

#### OUTSIDE

#### BALCONY

19' x 4' (5.79m x 1.22m)

#### PARKING

One allocated parking space

#### VIEWINGS

Strictly by appointment.

#### FREE VALUATION

Please contact us for a free market appraisal on your own property.



## First Floor

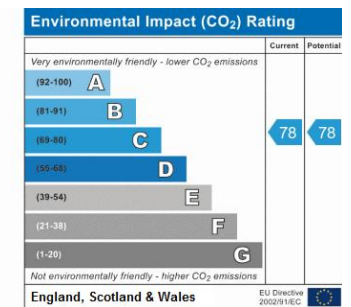
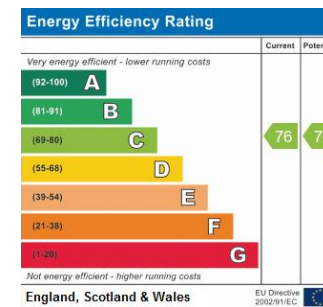
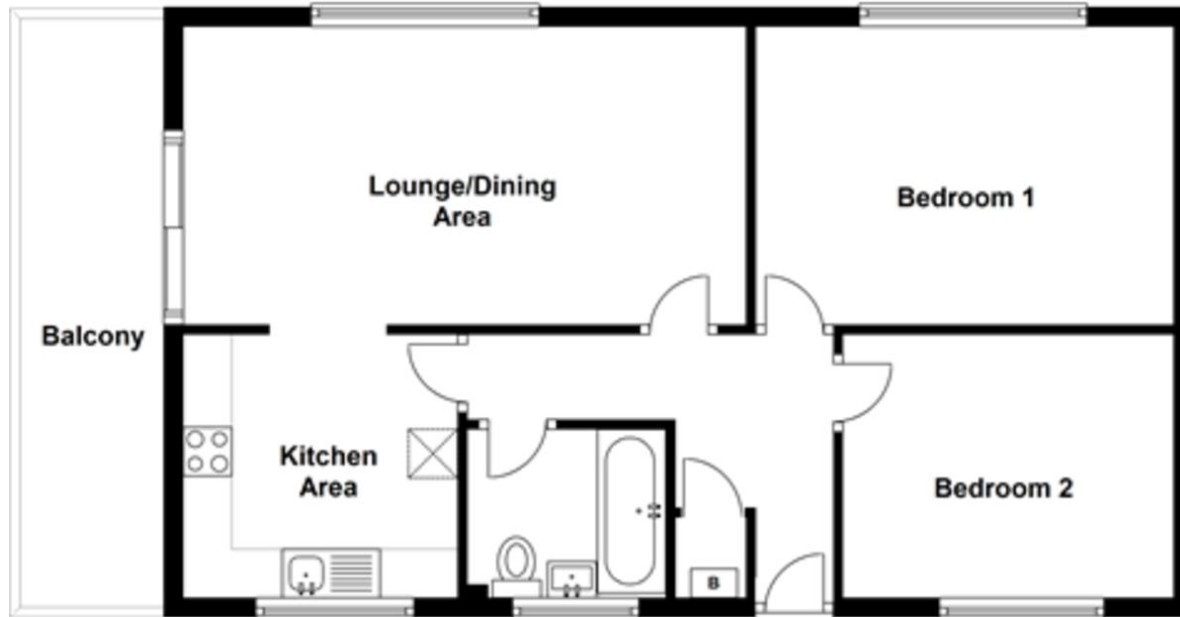

Agents Note: Whilst every care has been taken to prepare these sales particulars, they are for guidance purposes only. All measurements are approximate and for general guidance purposes only and whilst every care has been taken to ensure their accuracy, they should not be relied upon and potential buyers are advised to recheck the measurements.

50-52 Oxford Street  
Whitstable  
Kent  
CT5 1DG

www.davidclarke.co.uk  
01227 266644  
whitstable@davidclarke.co.uk  
k

Mon-Fri: 9am - 5.30pm  
Sat: 9am - 5pm  
Sun: 10am - 3pm

