



Rowleys Mill Uttoxeter New Road, Derby **Offers Over £81,000**





YOUR MOVE





Rowleys Mill Uttoxeter New Road, Derby

Offers Over £81,000

Property Description

Wow what a find! A third floor two bedroom apartment within walking distance of city centre and Royal Derby Hospital. The apartment has two excellent bedrooms making the apartment great for a couple or sharers, Bedrooms, Separate Kitchen, the lounge has a Juliette Balcony a is spacious and great for entertaining and the kitchen is modern with great storage. The apartment comes with allocated parking in secure gated car park and is located brilliantly to enjoy Derby's array of bars and restaurants.

Our View

This apartment would make an ideal investment or first time buy as it is located close to the city centre and has easy access to the Derby Royal hospital. There are two decent sized bedrooms a lounge and separate kitchen. A particular feature is the secure gated entrance and parking. Priced to sell.

Location

The area is approximately a five minutes walk away from the city centre which in offers everything you would expect from a bustling city centre. Good bus links can be found which lead into Derby and Nottingham.



City Centre Location
For full EPC please contact the branch

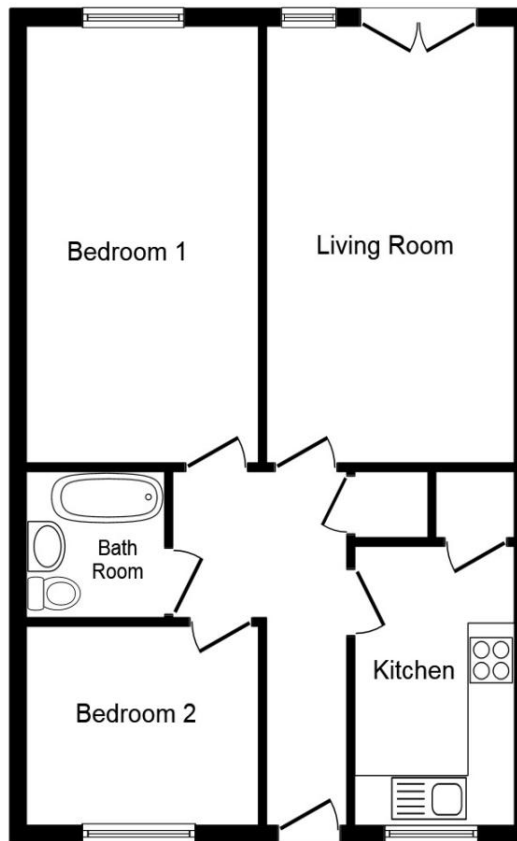

Floor Plan

This plan is for illustration purposes only and may not be representative of the property. Plan not to scale.

Powered by audioagent.com

IMPORTANT NOTE TO PURCHASERS: We endeavour to make our sales particulars accurate and reliable, however, they do not constitute or form part of an offer or any contract and none is to be relied upon as statements of representation or fact. The services, systems and appliances listed in this specification have not been tested by us and no guarantee as to their operating ability or efficiency is given. All measurements have been taken as guide to prospective buyers only, and are not precise. Floor plans where included are not to scale and accuracy is not guaranteed. If you require clarification or further information on any points, please contact us, especially if you are travelling some distance to view. Fixtures and fittings other than those mentioned are to be agreed with the seller.

Your Move is a trading name of your-move.co.uk, registered in England at Newcastle House, Albany Court, Newcastle Business Park, Newcastle upon Tyne NE4 7YB (number 01864469).

24 Iron Gate, Derby, DE1 3GP

01332 343406 * Derby@your-move.co.uk

*Calls may be recorded and/or monitored for training and/or security purposes.

