

Tel: 01923 677755
Fax: 01923 680729

www.claytons.co.uk

Claytons 



CRUSADER WAY, WATFORD - £475,000
3 Bedroom Semi-Detached House



3 bed semi-detached house set in a quiet crescent with garage and off street parking.

The ground floor comprises; good sized semi-open plan living room/dining room with access and views over the garden, fitted kitchen and downstairs W/C.

The first floor comprises; 3 good sized bedrooms and a large family bathroom.

To the exterior there is a well proportioned garden with patio area. The garden also benefits from side access.

To the front there is off street parking as well as an integrated garage.

Set on a quiet crescent opposite a large green space with children's play area, the house is also in close proximity to excellent schools, has easy access to the major road links of the M1 & M25 and is only a short distance to all local amenities.

- 3 bed semi-detached house
- 3 good sized bedrooms
- Semi open plan living / dining room
- Fitted Kitchen
- Large family bathroom
- Integrated garage
- Off Street Parking
- Garden with patio and side access

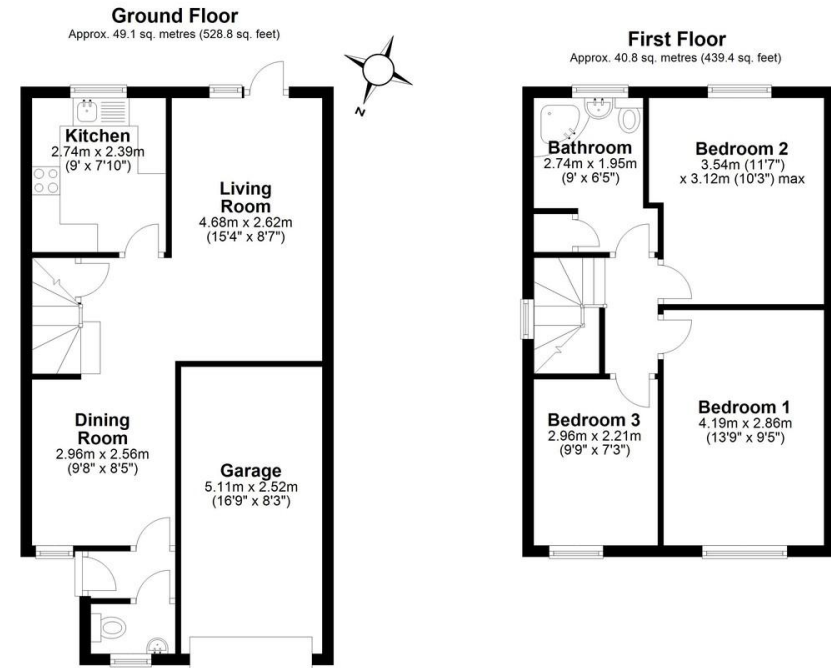

 VIEWING BY APPOINTMENT THROUGH CLAYTONS 01923 677755

FREE VALUATIONS & MARKETING ADVICE

Can we assist you in the sale of your property? If your home is situated within the catchment area of one of our sales offices we would be pleased to offer you a free valuation and market appraisal, a service which we provide without obligation. Competitive fees are always available for both sole and multiple agency. Please contact David Clayton on 01923 677755.

NB 1) We have not tested any appliances and/or services mentioned in these property particulars and do not intend to imply they are in full working order. Photographs are for illustrative purposes only and may show items that are not included in the sale of this property. 2) Due to Money Laundering Regulations 2003 we will ask all prospective purchasers for identification. 3) Buyers should seek verification from their solicitor about the legal title of this property.

These particulars are intended only to give fair description of the property, as a guide to prospective buyers. Accordingly, a) their accuracy is not guaranteed and neither Claytons nor the Vendor(s) accept any liability in respect of their contents; b) they do not constitute an offer or contract of sale, and c) any prospective purchaser should satisfy themselves by inspection or otherwise as to the correctness of any statements or information on these particulars.

Claytons & Hayes Ltd • Registered in England No. 2655243 • Registered Office: 4 Garston Park Parade, Garston, Watford, Herts WD25 9LQ • vat No. 579331903

See all our properties at www.claytons.co.uk

