

Offers In Excess Of **£275,000**

tel: **01442 214151**



Westerdale, Highfield, Hemel Hempstead HERTS HP2 5TX

Clements Estate Agents are delighted to offer to the market this lovely THREE bedroom split level maisonette benefiting an excellent range of features including very good decorative order with a modern fitted kitchen and bathroom, spacious room sizes, double glazing, gas central heating and a convenient residential location set close to amenities. VIEWING VERY MUCH ADVISED!

- DUPLEX MAISONETTE
- THREE BEDROOMS
- FIRST & SECOND FLOOR
- EXCELLENT DECORATIVE ORDER
- PARKING



Property Description

Clements Estate Agents are delighted to offer to the market this lovely THREE bedroom split level maisonette benefiting an excellent range of features including very good decorative order with a modern fitted kitchen and bathroom, spacious room sizes, double glazing, gas central heating and a convenient residential location set close to amenities.

ENTRANCE

Front door to

ENTRANCE HALLWAY

Well decorated with a built in cupboard, stairs rising to first floor landing.

FIRST FLOOR LANDING

Well decorated with a wall mounted radiator, large built in cupboard, UPVC double glazed window to front, stairs rising to second floor landing, doors to kitchen & lounge/diner

LOUNGE/DINER

17' 8" x 15' 4" (5.38m x 4.67m)

A large well decorated room with wood effect flooring, ample power points including USB socket, two radiators, UPVC double glazed windows to rear

KITCHEN/BREAKFAST ROOM

12' 6" x 11' 6" (3.81m x 3.50m)

A modern luxury kitchen comprising full range of fitted floor and wall mounted units with drawers & solid oak work tops over. Integrated oven and hob with glass splash back and extractor hood over. Sink and drainer unit with mixer tap, free standing dishwasher and washing machine, floor space for fridge/freezer, ample power points with USB socket, radiator, wood effect flooring, inset ceiling LED lighting, UPVC double glazed windows to front

SECOND FLOOR LANDING

Stairs to the second floor landing, storage cupboard housing the boiler, doors to all bedrooms and family bathroom

MASTER BEDROOM

13' 8" x 10' 8" (4.16m x 3.25m)

Radiator, ample power points with USB socket, UPVC double glazed windows to rear

BEDROOM TWO

12' 8" x 8' 7" (3.86m x 2.61m)

Radiator, ample power points with USB socket, UPVC double glazed windows to front

BEDROOM THREE

8' 8" x 8' 8" (2.64m x 2.64m)

Radiator, ample power points with USB socket, UPVC double glazed windows to rear

BATHROOM

A luxury bathroom suite comprising P- shaped panelled bath with wall mounted shower unit and fitted screen.

Low level WC, wash hand basin, fully tiled walls and flooring, wall mounted mirror fronted cabinet, fully tiled, heated towel rail, UPVC double glazed window to front

OUTSIDE

Driveway offering parking for one car.



Tenure **Share of Freehold**

Council Tax Band

Viewing Arrangements **Strictly by appointment**

Contact Details

142 Marlowes

Hemel Hempstead

Hertfordshire

HP1 1EZ

Email: sales@clementsestateagents.co.uk

Tel: 01442 214151

www.clementsestateagents.co.uk

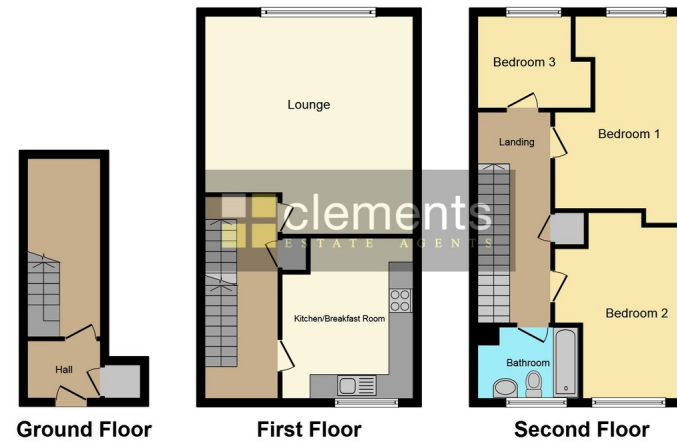

The Floor Plan is for illustration purposes only and may not be representative of the property. The position and size of doors, windows and other features are approximate. Unauthorized reproduction prohibited. © PropertyBOX

%epcGraph_c_1_349%

Agents Note: Whilst every care has been taken to prepare these sales particulars, they are for guidance purposes only. All measurements are approximate and are for general guidance purposes only and whilst every care has been taken to ensure their accuracy, they should not be relied upon and potential buyers are advised to recheck the measurements.