



Turpins Rise

Stevenage | SG2 8QZ

Agent Hybrid

# Turpins Rise

Stevenage | SG2 8QZ

£325,000



Agent Hybrid welcomes to the market, a very well presented, Two Bedroom Semi Detached Home, located in the Broadwater area of Stevenage. The property is located for easy access to the A1M and is only a 1.4 mile walk to the Town Centre. Accommodation briefly comprises of; An Hallway, with open storage recess under the stairs and doors leading to the Kitchen and Lounge/Diner. The kitchen is fitted with matching tiled floor to the hallway and contemporary, grey shaker style units, with integral tall standing fridge freezer and space for a washing machine and tumble dryer. The Lounge/Diner stretches across the entire back of the house and central French doors leading out to the rear garden. Stairs rise to the first-floor landing, where you will find an airing cupboard housing a combi boiler and doors to Two Large Double Bedrooms and a Bathroom, fitted with a white three-piece suite, a rainfall shower head over the bath and metro wall tiling. Externally, the property benefits from a Private, Southwest Facing Rear Garden, with patio seating area leading to the lawn and convenient gated access to the side. Viewing comes recommended.

**Entrance Hallway**      **Bedroom 1: 10'6 x 10'6**  
**Kitchen 10'7 x 7'4**      **Bedroom 2: 13'10x10'0**  
**Lounge/Diner 20'9 x 9'2**      **Bathroom 6'4 x 5'5**

## Ground Floor

Approx. 32.2 sq. metres (347.0 sq. feet)

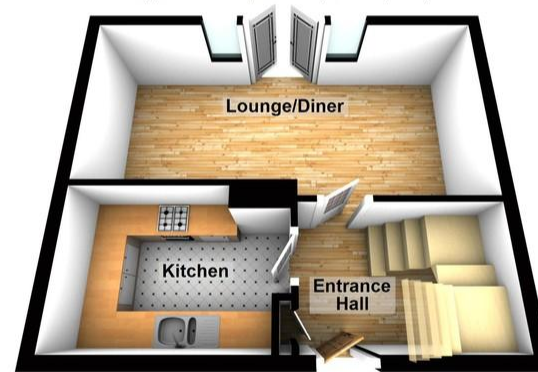

## First Floor

Approx. 32.1 sq. metres (345.5 sq. feet)

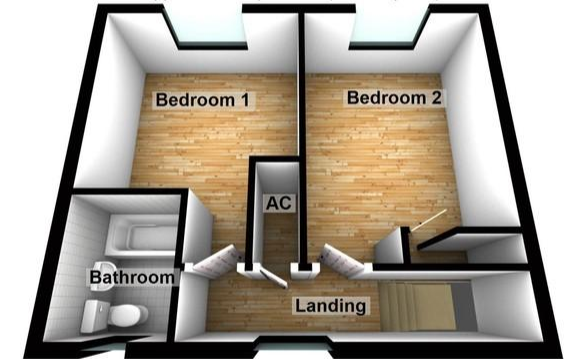

Total area: approx. 64.3 sq. metres (692.5 sq. feet)

EPC TO FOLLOW

IMPORTANT: we would like to inform prospective purchasers that these sales particulars have been prepared as a general guide only. A detailed survey has not been carried out, nor the services, appliances and fittings tested. Room sizes should not be relied upon for furnishing purposes and are approximate. If floor plans are included, they are for guidance only and illustration purposes only and may not be to scale. If there are any important matters likely to affect your decision to buy, please contact us before viewing the property.

**Agent Hybrid**

57 High Street, Stevenage, Hertfordshire, SG1 3AQ  
Tel: 01438 870673 | enquiries@agenthybrid.co.uk  
[www.agenthybrid.co.uk](http://www.agenthybrid.co.uk)

**Agent Hybrid**