



Seymours



## Jays Nest Close Camberley, GU17 0BQ

£500,000

Council Tax Band E

£2,428.62

Freehold

Arrange a viewing: 01276 534100

## Property Details

4 bedrooms

1 bath

EPC Rating TBC

1067 sq ft

Blackwater

- No onward chain
- Four bedrooms
- Bathroom
- Cloakroom
- Living room
- Dining room
- Predominantly Westerly facing rear garden
- Garage and driveway

Convenient for Blackwater and the local



Brought to the market with no onward chain this detached four bedroom home offers four bedrooms and a bathroom as well as two reception rooms and a kitchen with also a downstairs cloakroom. To the rear of the property is a predominantly west facing garden and there is a driveway leading to a detached garage. The house is ideally located in this popular close which is very convenient for Blackwater and the local shops, amenities and railway station as well as good local schools.

01276 534100 / [james@seymours-blackwater.co.uk](mailto:james@seymours-blackwater.co.uk)

### Jays Nest Close

Approximate Gross Internal Area = 99.1 sq m / 1067 sq ft  
(Excluding Garage)

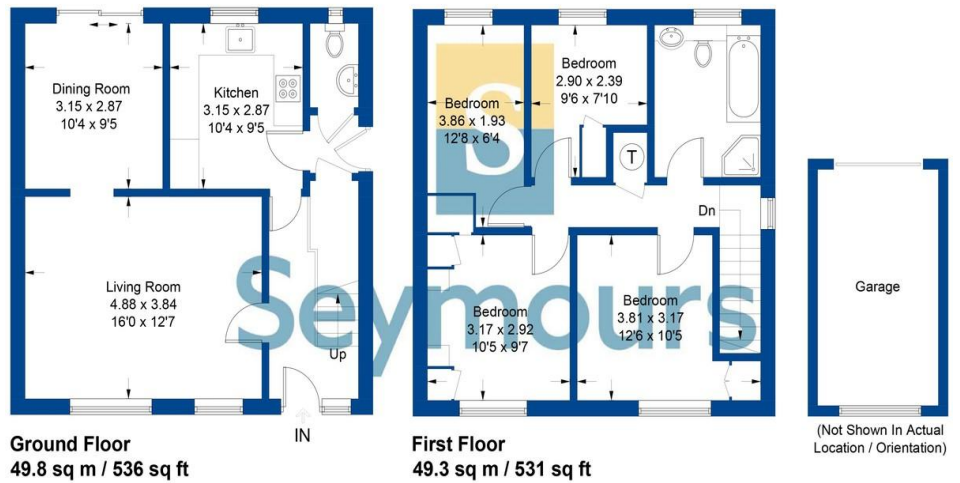

Illustration for identification purposes only, measurements are approximate, not to scale. FloorplansUsketch.com © 2023 (ID955970)