

WYNDHAM AVENUE, EXETER, EX1 2PQ

GUIDE PRICE - £375,000





WYNDHAM AVENUE, EXETER, EX1 2PQ

- ❖ Presented To A High Spec
- ❖ Recently Renovated Modern Design Throughout
- ❖ Open Plan Kitchen / Dining Room
- ❖ Utility Room
- ❖ Gas Central Heating & Double Glazed Windows
- ❖ Downstairs WC
- ❖ Sunny Garden with a Shed
- ❖ Local Amenities On Your Doorstep
- ❖ Easy access to the M5 & A30
- ❖ Excellent transport links close by

This stunning 3 bedroom home has been fully renovated to an extremely high standard and is beautifully presented throughout.. Located only minutes from Exeter RD&E and City Centre the location is ideal for a working professional.

Well regarded primary & secondary schools are within easy access of the property, as is Heavitree Park. The property is conveniently located close to a bus route, train station and is well situated for access to major road links including the M5 and A30.

The bright entrance hall to this property leads to the rooms on the lower floor and to the stairs.

The living room is radiating with character with a stunning feature fireplace and large bay window.



The kitchen/diner is extremely spacious and consists of modern cabinets with plenty of space for kitchen essentials and ample space for appliances. The glass door allows light to flood the room and gives access to the rear garden. There is an additional floor to ceiling window which is an excellent feature.

The utility room is another unique feature of this wonderful home. There is also access to a WC.

On the first floor of the property, we have 3 good sized bedrooms 2 of which are doubles and all have feature fireplaces. The family bathroom is also located on this floor and consists of a bath with shower overhead, WC and hand wash basin. The bifold door gives extra space.

The low maintenance garden is a great space for entertaining and al fresco dining. There is a patio area and large shed. The garden gives rear access.







Approx Gross Internal Area  
82 sq m / 878 sq ft

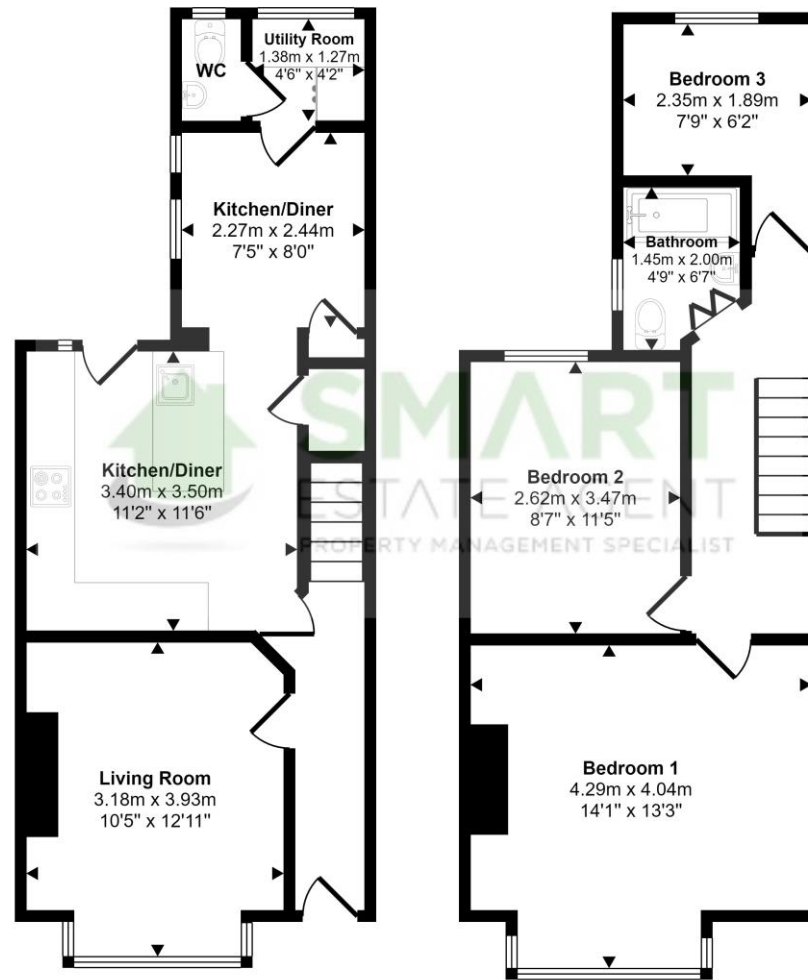

Ground Floor  
Approx 40 sq m / 435 sq ft

First Floor  
Approx 41 sq m / 443 sq ft

This floorplan is only for illustrative purposes and is not to scale. Measurements of rooms, doors, windows, and any items are approximate and no responsibility is taken for any error, omission or mis-statement. Icons of items such as bathroom suites are representations only and may not look like the real items. Made with Made Snappy 360.