



Colegrove Road | London | SE15 6NL

Leasehold

£425,000

- Top floor
- Balcony
- Two double bedrooms
- Excellent storage!
- Communal garden
- Secure parking
- Secure bike storage
- Well presented
- Excellent transport links
- Peckham nightlife



Well presented top floor apartment, with gated parking, communal garden and secure bicycle storage. Lots of natural light and well laid out. There are two double bedrooms, large lounge, well fitted kitchen with breakfast bar and a sunny balcony looking out towards the Surrey canal path. The apartment is about 15 years old and has reasonably low outgoings, making it perfect for first time buyers. A great location with swift access into the City, West End and Central London. Perfect for cycle commuters with cycle routes taking through the local parks. Peckham Rye station is nearby along with numerous excellent bus routes. Peckham levels, Bussey building, nightlife and eateries make this a popular location to live.

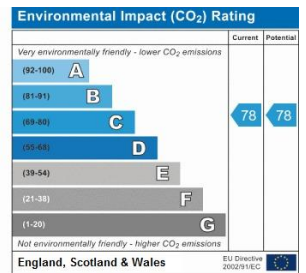
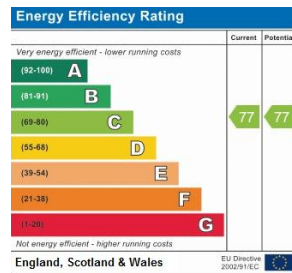

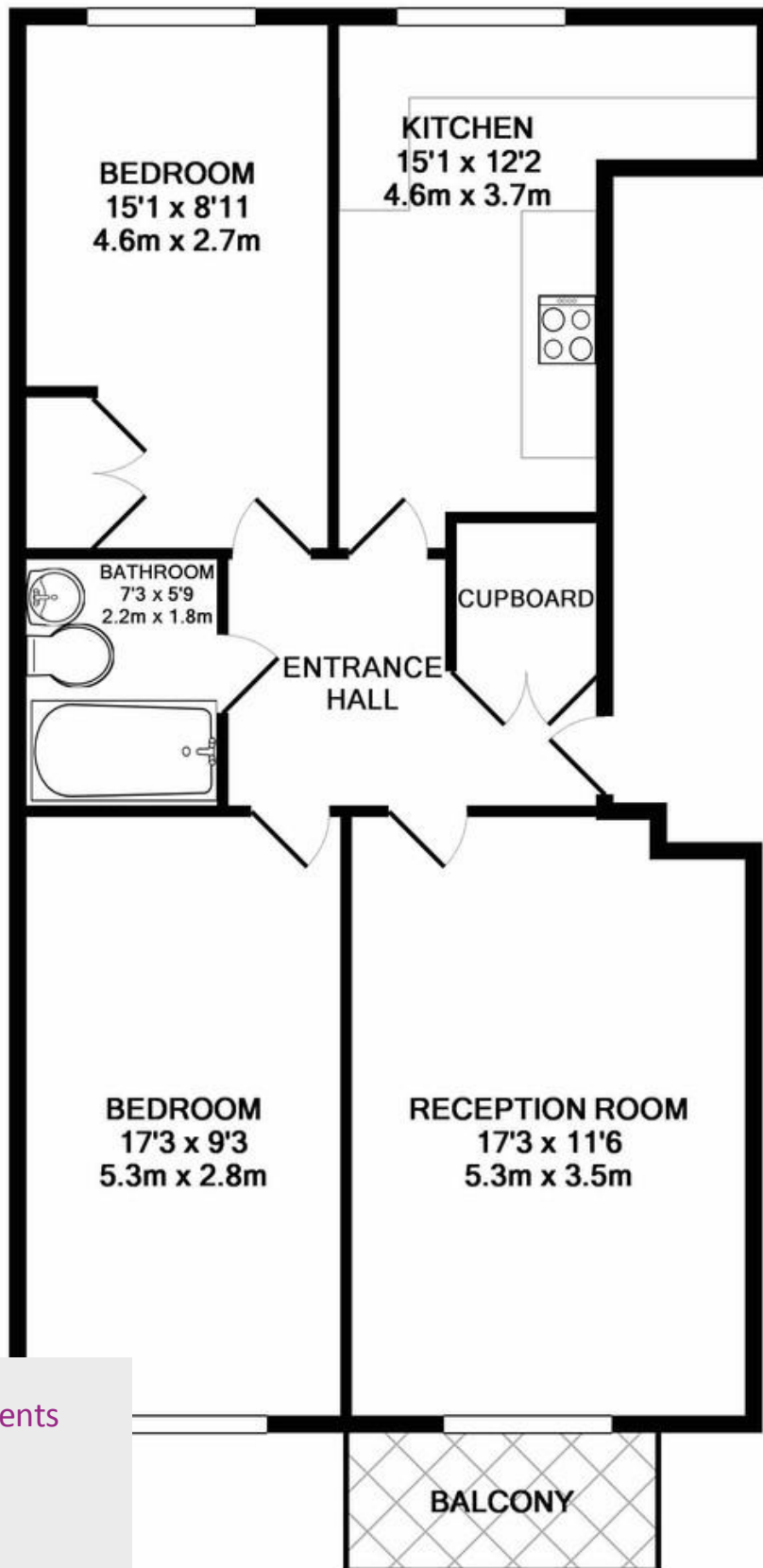

Viewing Arrangements

Strictly by appointment

Contact Details

121 Denmark Hill

London

SE5 8EN

www.urbanvillagehomes.co.uk

sales@urbanvillagehomes.com

020 3519 9121

TOTAL APPROX. FLOOR AREA 744 SQ.FT. (69.1 SQ.M.)

Measurements have been made to ensure the accuracy of the floor plan contained here, measurements of rooms, fixtures and fittings and any other items are approximate and no responsibility is taken for any error, omission or inaccuracy. This plan is for illustrative purposes only and should be used as such by any potential buyer.

Agents Note: Whilst every care has been taken to prepare these sales particulars, they are for guidance purposes only. All measurements are approximate and for general guidance purposes only and whilst every care has been taken to ensure their accuracy, they should not be relied upon and potential buyers are advised to recheck the measurements.