



Seymours



Green Lane
Camberley, GU17 9DH
£500,000

Arrange a viewing: 01276 534100

Property Details

- 3 bedrooms
- 1 baths
- EPC Rating TBC
- 1197 sqft
- Blackwater Station (0.3 miles)

- Character detached home
- No onward chain
- Three bedrooms
- Living room
- Dining room
- Large conservatory
- Cloakroom and shower room
- Mature rear garden
- Convenient location

NO ONWARD CHAIN. A well presented detached three bedroom home which benefits from two reception rooms as well as a downstairs cloakroom and a large conservatory. The property also has a mature rear garden as well as driveway parking for two cars. Upstairs also benefits from a modern shower room and there is also a useful loft room which has been boarded and plastered and decorated as well as having a velux window. The house is very conveniently located for Blackwater and the local shops, amenities and railway station as well as good local schools and attractive countryside at Hawley woods and Yateley common close by.

01276 534100 / james@seymours-blackwater.co.uk

Green Lane

Approximate Gross Internal Area
Ground Floor = 65.6 sq m / 706 sq ft
First Floor = 45.6 sq m / 491 sq ft
Total = 111.2 sq m / 1197 sq ft

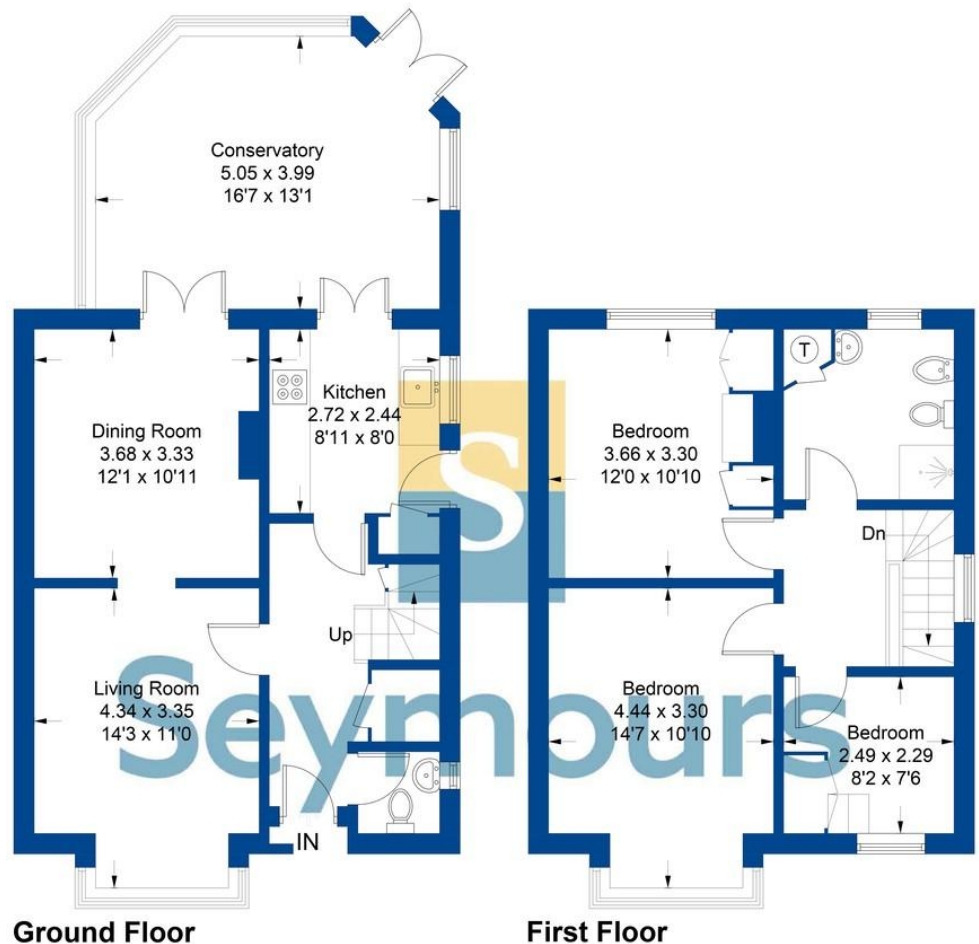

Illustration for identification purposes only, measurements are approximate, not to scale. FloorplansUsketch.com © 2024 (ID1067081)