

22 Belgrave Road ,  
Chester

£575,000

CURRANS  
*homes*



This rare opportunity to view a superbly improved and extended 1930's semi detached home. With a stunning full width rear extension together with a full loft conversion to provide four good sized bedrooms with a large master suite which provides a dressing area and large en-suite shower room.

To the ground floor there is stylishly decorated accommodation with an entrance hall with ornate tiled flooring, good sized cloakroom/w/c, living room, open plan 25ft x 20ft living/dining/kitchen with a large central island, quartz work surfaces with a contemporary fitted kitchen, full width patio doors opening onto a westerly facing patio which opens onto a large private rear garden, utility room.

To the first floor there are three bedrooms including two good sized doubles and a sumptuous family bathroom.

These particulars are intended to give a fair and substantially correct overall description for the guidance of intending purchasers and do not constitute an offer or part of a contract. Prospective purchasers ought to seek their own professional advice. All descriptions, dimensions, areas, reference to condition and necessary permissions for use and occupation and other details are given in good faith and are believed to be correct, but any





intending purchasers should not rely on them as statements or representations of fact, but must satisfy themselves by inspection or otherwise as to the correctness of each of them. All measurements are approximate.

**Tenure:** Freehold

**Local Authority:**

**Council Tax:** Band

**Viewings:** By appointment only

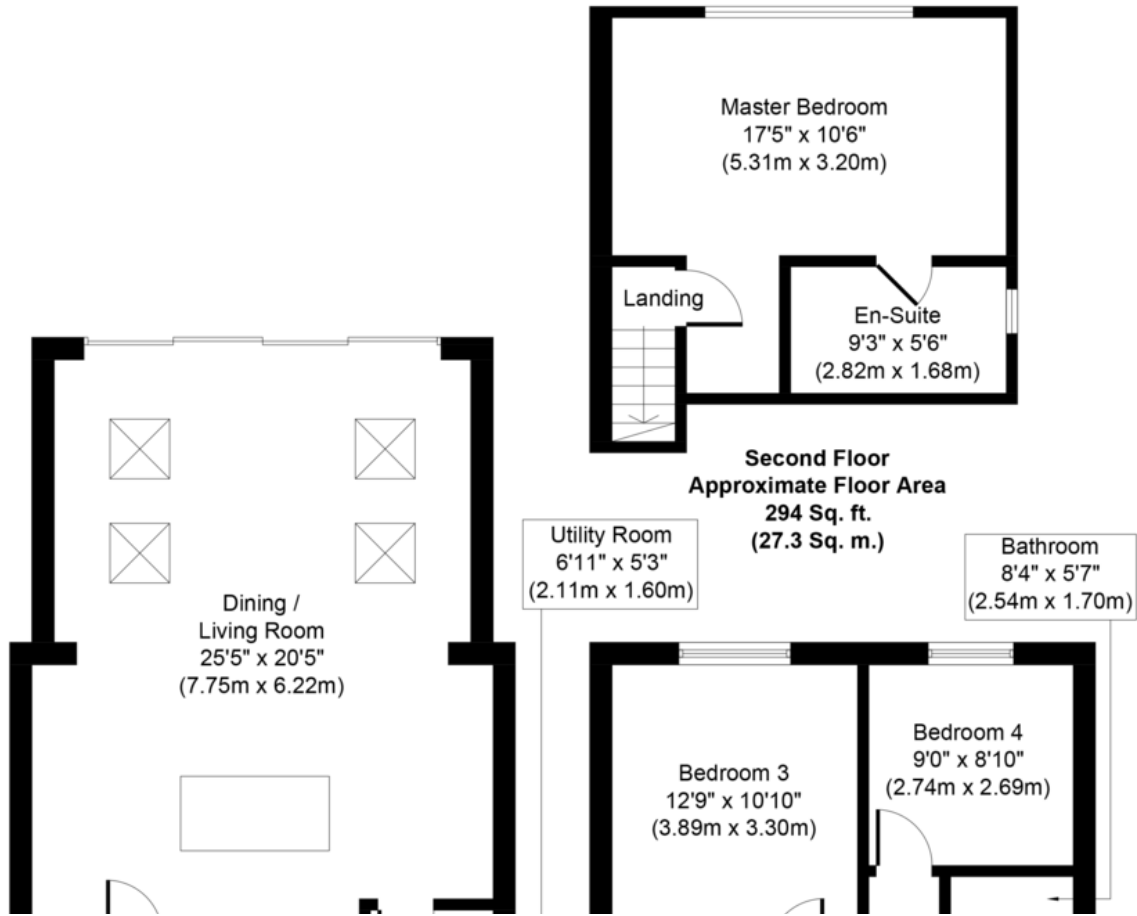

**Office Address**

11 Grosvenor Street  
Chester, Cheshire  
CH1 2DD

**01244 313900**

**sales@curranshomes.co.uk**

