

PARK VIEW, PROSPECT PLACE, EX4 1JA

GUIDE PRICE £210,000 - £220,000





A well presented two bedroom ground floor flat with master bedroom en-suite, large living room & allocated parking space in a convenient level location and within close proximity to the City Centre, Local schools, Shops & Doctors surgery.

Modern and airy feel throughout, this good sized 2 bedroom ground floor apartment in the heart of St Thomas has a fantastic woodland view over St Thomas Park.

Benefitting from a large open plan lounge which leads to a rear patio & garden space backing on to the park, modern kitchen area with built in appliances, 2 double bedrooms with en-suite shower room to the master and main bathroom with modern 3 piece white suite. The apartment also benefits from an allocated parking space.

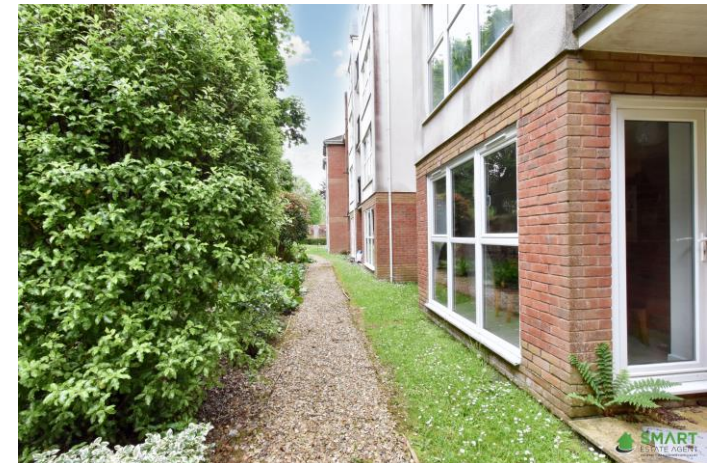



Approx Gross Internal Area  
59 sq m / 637 sq ft

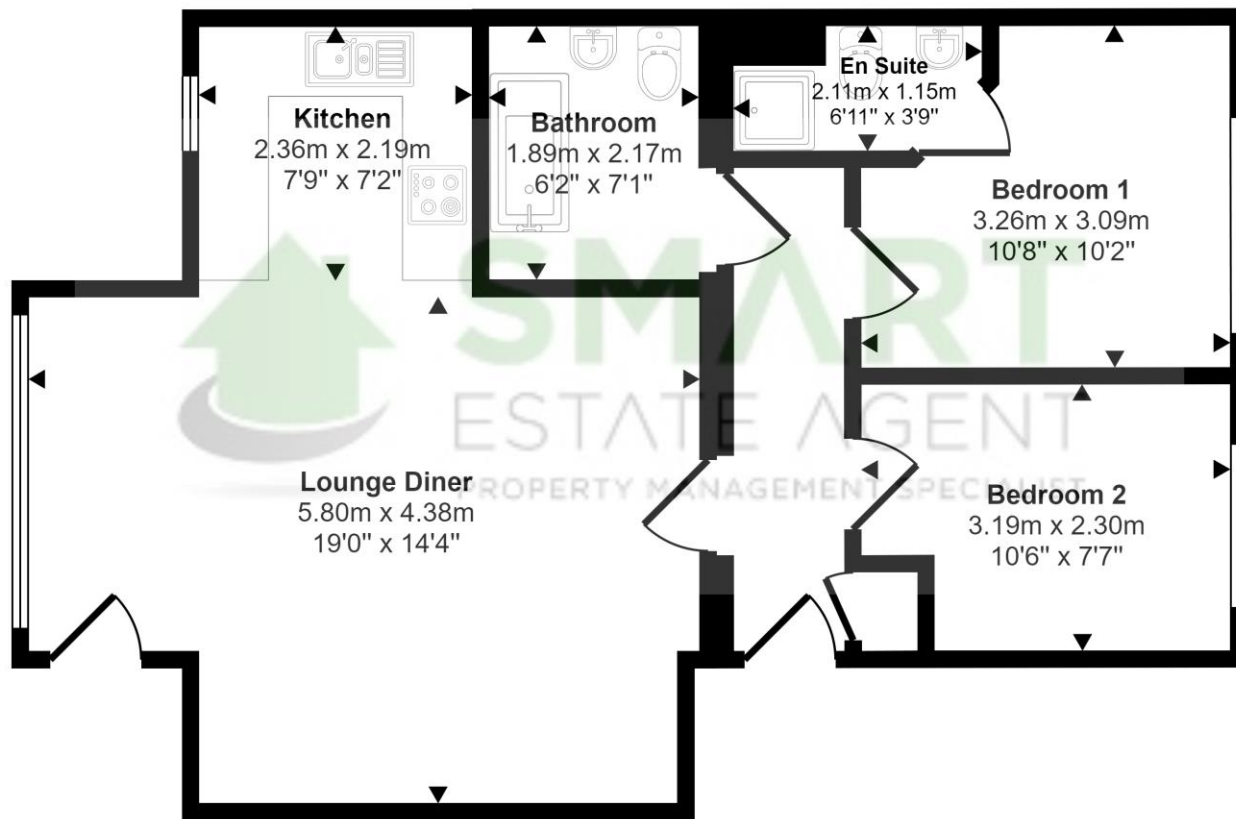

Floorplan

Score	Energy rating	Current	Potential
92+	A		
81-91	B		
69-80	C	79 C	80 C
55-68	D		
39-54	E		
21-38	F		
1-20	G		

This floorplan is only for illustrative purposes and is not to scale. Measurements of rooms, doors, windows, and any items are approximate and no responsibility is taken for any error, omission or mis-statement. Icons of items such as bathroom suites are representations only and may not look like the real items. Made with Made Snappy 360.