

SAMPLE MILLS



Northumberland Place
Teignmouth
Devon

£80,000

LEASEHOLD





**Northumberland Place, Teignmouth,
Devon**

£80,000 Leasehold

**Sold via Secure Sale online bidding. Terms
& Conditions apply. Starting Bid £80,000.**

**A refurbished 1 bedroom flat situated close
to the town centre of Teignmouth within
walking distance to the shops, pubs and
restaurants, railway station and sea front.**

**The internal accommodation comprises
entrance hall leading to the modern fitted
kitchen, lounge, double bedroom and
shower room. The property has electric
heating.**

**This property would make an ideal 'buy to
let' or holiday home.**



Communal Entrance

Door opening through to:

Entrance Hall

Electric wall heater. Cupboard housing electric meter. Door opening through to:

Lounge – 3.28m x 2.67m (10'9" x 8'9")

TV point. Window overlooking the front. Laminate flooring. Electric wall heater. Telephone point, Intercom system. Steps down to:

Double Bedroom – 3.25m x 2.95m (10'8" x 9'8")

Electric wall heater. Window with a similar outlook to the lounge. Laminate flooring.

Kitchen – 2.51m x 2.21m (8'3" x 7'3")

Inset stainless steel single drainer sink unit with mixer taps. Fitted matching wall and base units. Electric cooker point. Space for fridge/freezer. Partly tiled walls. Extractor fan.

Shower Room – 2.34m x 1.45m (7'8" x 4'9")

Shower cubicle with fitted shower. Low level w/c. Wall mounted wash-hand basin. Partly tiled walls. Obscure double glazed window.

Agents Note

Council Tax Band: 'A' £1640.00 for 2024/25

EPC Rating: 'E'

Tenure: Leasehold 992 years remaining on Lease

Service Charge: £600.00 per annum (£50 pcm)

Ground Rent: £125.00 per annum

Sold via Secure Sale online bidding. Terms & Conditions apply. Starting Bid £80,000



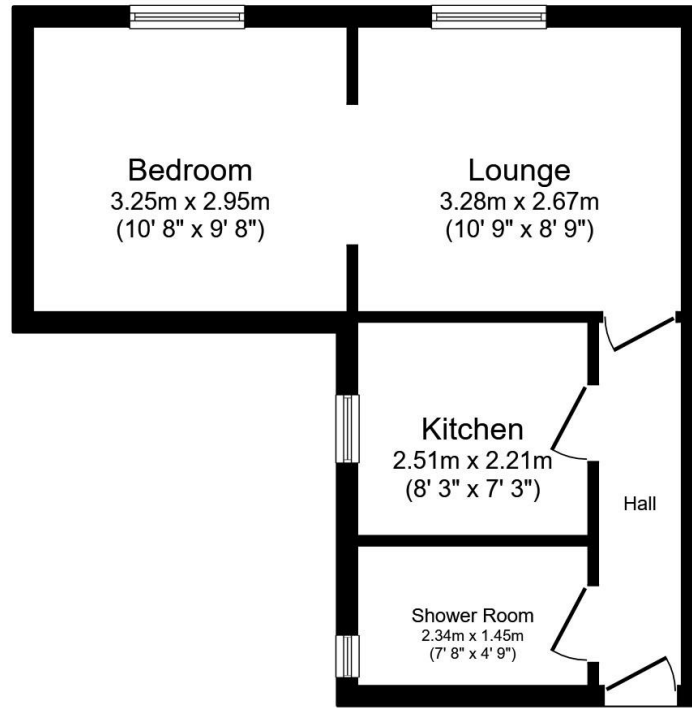

Floor Plan

Floor area 32.7 m² (352 sq.ft.)

TOTAL: 32.7 m² (352 sq.ft.)

This floor plan is for illustrative purposes only. It is not drawn to scale. Any measurements, floor areas (including any total floor area), openings and orientations are approximate. No details are guaranteed, they cannot be relied upon for any purpose and do not form any part of any agreement. No liability is taken for any error, omission or misstatement. A party must rely upon its own inspection(s). Powered by www.Propertybox.io



3 Bank Street
Newton Abbot
TQ12 2JL

Tel: 01626 367018
sales@samplemills.co.uk

www.samplemills.co.uk

[rightmove](#) [Zoopla.co.uk](#) [PrimeLocation.com](#)

Score	Energy rating	Current	Potential
92+	A		
81-91	B		
69-80	C		77 C
55-68	D		
39-54	E	41 E	
21-38	F		
1-20	G		

IMPORTANT: we would like to inform prospective purchasers that these sales particulars have been prepared as a general guide only. A detailed survey has not been carried out, nor the services, appliances and fittings tested. Room sizes should not be relied upon for furnishing purposes and are approximate. If floor plans are included, they are for guidance only and illustration purposes only and may not be to scale. If there are any important matters likely to affect your decision to buy, please contact us before viewing the property.