



60

Andrew Pearce
PINNER

WILTSHIRE LANE, PINNER, MIDDLESEX HA5 2LU

£525,000



Situated in a highly sought-after area, this charming two-bedroom semi-detached bungalow is conveniently close to the amenities and transport links of Northwood Hills.

It is also near several esteemed schools, including Haydon Secondary and Coteford Infant and Junior.

The property features a porch and a small hallway that opens into a spacious reception room, leading to another hallway. Off this hallway, you'll find the main bedroom with fitted wardrobes, a second double bedroom, a well-appointed shower room, and a stylish fitted kitchen. The kitchen opens to the rear garden.

Externally, the property boasts a driveway offering off-street parking and access to the garage. The private rear garden includes a paved patio area, perfect for summer entertaining, with the remainder laid to lawn.

Wiltshire Lane is ideally located for excellent shopping and transport facilities in Northwood Hills, Ruislip, and Eastcote.

Offered for sale with no upward chain.



OUTBUILDINGS
145 sq. ft. (13.4 sq.m.) approx.

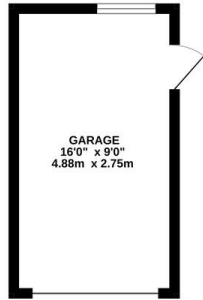

GROUND FLOOR
655 sq. ft. (60.8 sq.m.) approx.

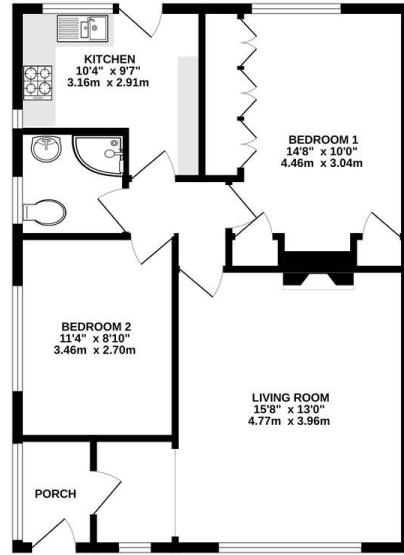

TOTAL FLOOR AREA: 799 sq. ft. (74.3 sq.m.) approx.
While every attempt has been made to ensure the accuracy of the drawings contained here, measurements of doors, windows, rooms and any other details are approximate and no responsibility is taken for any error, omission or misstatement. This plan is for illustrative purposes only and should be used as such by any prospective purchaser. The services, systems and appliances shown have not been tested and no guarantee is given for their operability or efficiency can be given.
Made with Metropix ©2024



