

**654 Holburn Street
Ground Right
Aberdeen**

Ground Floor

Approx. 32.8 sq. metres (353.3 sq. feet)

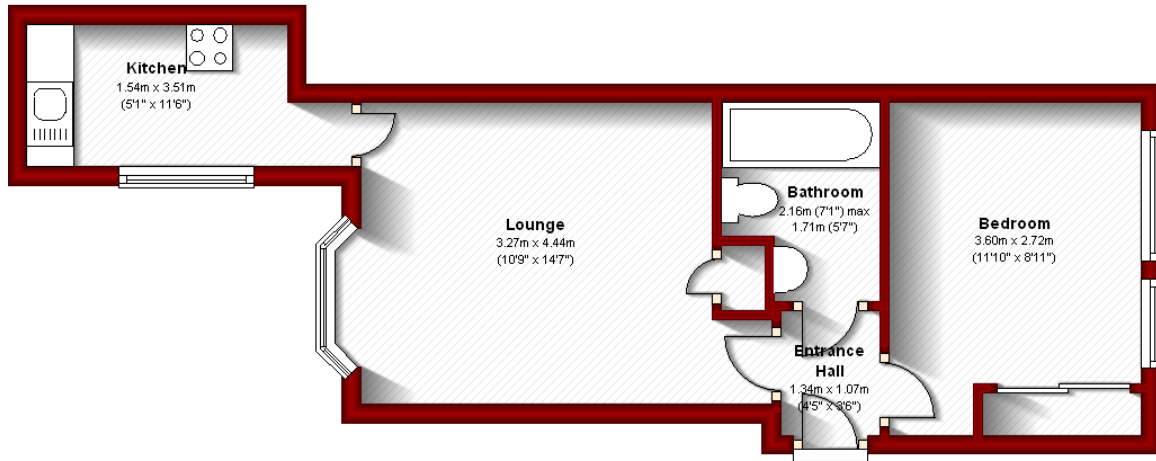

Total area: approx. 32.8 sq. metres (353.3 sq. feet)

The above particulars are for guidance only, no liability for any errors or omissions will be accepted by Aberdeen Property Leasing Ltd.