



Brightest move

WYNTER CLOSE, WORLE, BS22 7TD
RENT £795 PCM





We are pleased to offer this Two bedroomed Second Floor Flat in a popular location of Worle providing excellent access to amenities and transport links. The property briefly comprises Lounge, Kitchen, Two Bedrooms, Office and Family Bathroom. Further Benefits include Gas Central Heating and Double Glazing. AVAILABLE NOW (EPC Rating - C) Sorry NO Pets



GROUND FLOOR

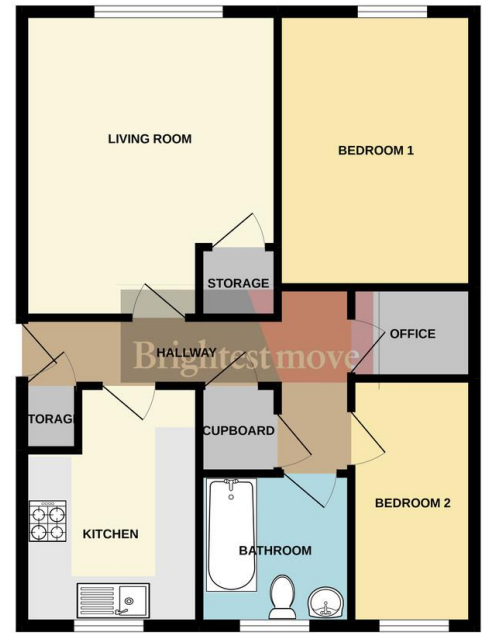

Whilst every attempt has been made to ensure the accuracy of the Diagrams contained herein, measurements of doors, windows, rooms and any other items are approximate and no responsibility is taken for any errors, omissions or mis-statements. This plan is for illustrative purposes only and should be used as such by any prospective purchaser. The services, systems and appliances shown have not been tested and no guarantee as to their operability or efficiency can be given. Made with Metropix i2022

Energy Efficiency Rating		Current	Potential
Very energy efficient - lower running costs			
(92-100)	A		
(81-91)	B		
(69-80)	C	71	77
(55-68)	D		
(39-54)	E		
(21-38)	F		
(1-20)	G		
Not energy efficient - higher running costs			
England, Scotland & Wales		EU Directive 2002/91/EC	

Environmental Impact (CO ₂) Rating		Current	Potential
Very environmentally friendly - lower CO ₂ emissions			
(92-100)	A		
(81-91)	B		
(69-80)	C	70	79
(55-68)	D		
(39-54)	E		
(21-38)	F		
(1-20)	G		
Not environmentally friendly - higher CO ₂ emissions			
England, Scotland & Wales		EU Directive 2002/91/EC	