



Seymours



Thornfield Green Camberley, GU17 9EY £240,000

Arrange a viewing: 01276 534100

Property Details

- 2 bedrooms
- 1 baths
- EPC Rating TBC
- 652 sqft
- Blackwater Station (0.8 miles)

- NO ONWARD CHAIN
- Two bedrooms
- Modern kitchen and bathroom
- Spacious living room
- 999 Year lease from 1987
- Share of freehold
- Service charge currently £1343.50 per annum
- Council tax band C £2044.46 per annum
- Walking Distance to Blackwater Train Station

NO ONWARD CHAIN. A beautifully presented and well modernised two bedroom apartment with refitted kitchen and bathroom and a spacious Living room. The property also benefits from being share of freehold and is located near the end of this popular close being nicely tucked away yet also very convenient for local shops, amenities and railway station as well as good local schools and attractive countryside at Hawley Woods and Blackwater Nature reserve.

[01276 534100](tel:01276534100) / james@seymours-blackwater.co.uk



Thornfield Green

Approximate Gross Internal Area = 60.5 sq m / 652 sq ft

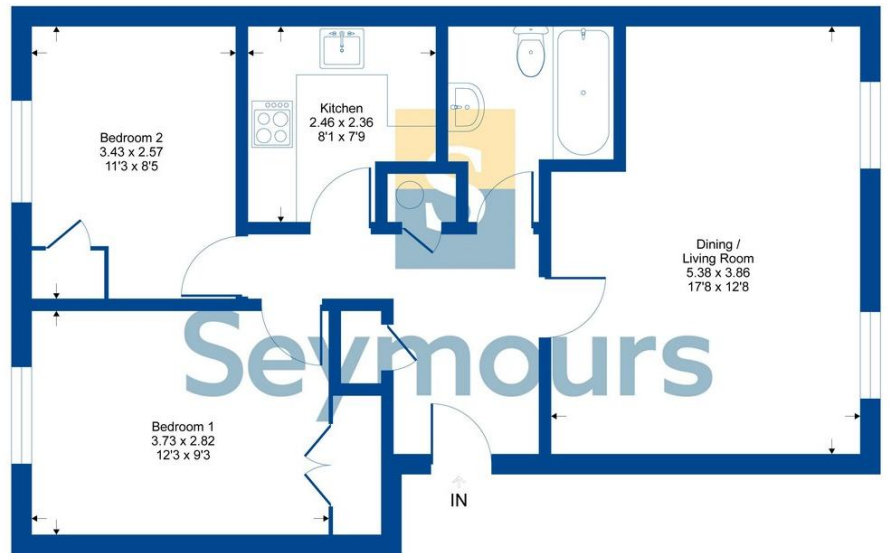

First Floor = 60.5 sqm / 652 sqft

Whilst every attempt has been made to ensure the accuracy of the floor plan contained here, measurements of doors, windows, rooms and any other items are approximate and no responsibility is taken for any error, omission or mis-statement. This plan is for illustrative purposes only and should be used as such by any prospective purchaser.