



Andrew Pearce
PINNER

GRANVILLE PLACE , ELM PARK ROAD, HA5 3NL

£370,000



Ideal for first-time buyers or investors, this charming two-bedroom apartment is situated just a stone's throw from Pinner High Street and Pinner Underground Station, offering the perfect blend of convenience and modern living. With no onward chain, this well-maintained property is ready to move in.

Step inside to find a welcoming entrance hallway with handy storage, leading to a spacious living/dining room with a window that floods the space with natural light.

The contemporary kitchen is fully equipped with an integrated hob and oven, perfect for preparing meals at home. Two good-sized double bedrooms offer plenty of space, while the modern family bathroom features a sleek three-piece suite.

Outside, residents can enjoy well-kept communal gardens and the added benefit of parking.

Located in the highly sought-after Granville Place, this apartment is just moments from a variety of shopping, dining, and leisure options, including local supermarkets, coffee shops, and restaurants. For commuters, Pinner Underground Station is within easy reach, offering a quick and efficient service into Central London via the Metropolitan Line. T

he area also boasts parks, recreational facilities, and places of worship, making it a fantastic choice for both work and leisure.

Share of Freehold : Lease TBA but in excess of 900 years.

Local Authority: London Borough of Harrow

Council Tax: Band D

Energy Efficiency Rating: Band C

Don't miss out on this fantastic opportunity – contact us today to arrange a viewing!



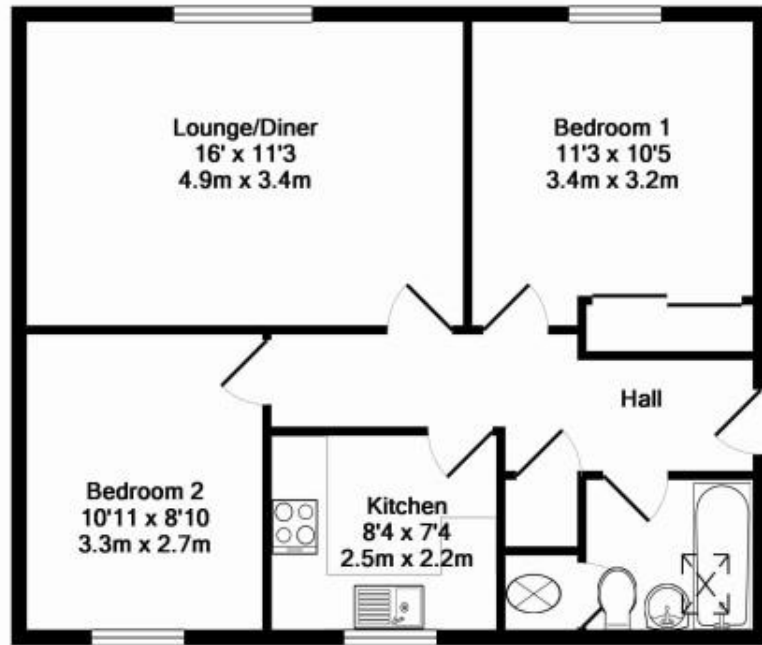

TOTAL APPROX. FLOOR AREA 587 SQ.FT. (54.5 SQ.M.)

Whilst every attempt has been made to ensure the accuracy of the floor plan contained here, measurements of doors, windows, rooms and any other items are approximate and no responsibility is taken for any error, omission, or mis-statement. This plan is for illustrative purposes only and should be used as such by any prospective purchaser. The services, systems and appliances shown have not been tested and no guarantee as to their operability or efficiency can be given.

Made with Metropix ©2011



