



Windrows, Skelmersdale, Lancashire **Offers in the region of £75,000**











Windrows, Skelmersdale,  
Lancashire

**Offers in the region of  
£75,000**



**EPC Grade E**  
**For full EPC please contact the branch**

## Property Description

A spacious and stylishly presented property situated in a quiet residential area in Old Town, Skelmersdale. The home offers an excellent opportunity for a young family with growing children as the rear garden is enclosed and is also within walking distance of St. Edmunds primary school. Gas central heating, double glazing and offered with no upward chain this property provides outstanding family accommodation and is well worthy of inspection. This end terraced property comprises entrance hall, kitchen, dining room and lounge to the ground floor whilst to the first floor there are three bedrooms, separate wc and family bathroom, externally there is a small garden area to the front of the property and a garden to the rear also. A copy of the EPC will be available on request. EPC grade E

## Our View

This is an excellent opportunity to purchase a versatile three bedroom family home in a great location appealing to both families and investors alike.

## Location

Windrows is located in the Old Town area of Skelmersdale which has easy access to Sandy Lane shopping centre, there is a bus route through from Wigan to Ormskirk. The property has excellent road links as well as access to M58 and M6 motorways. Ashurst Beacon Country Park and Golf Club is nearby as well as the Concourse town centre.

Ground Floor  
Floor Size: 32.0 m<sup>2</sup>, 344.4 ft<sup>2</sup>

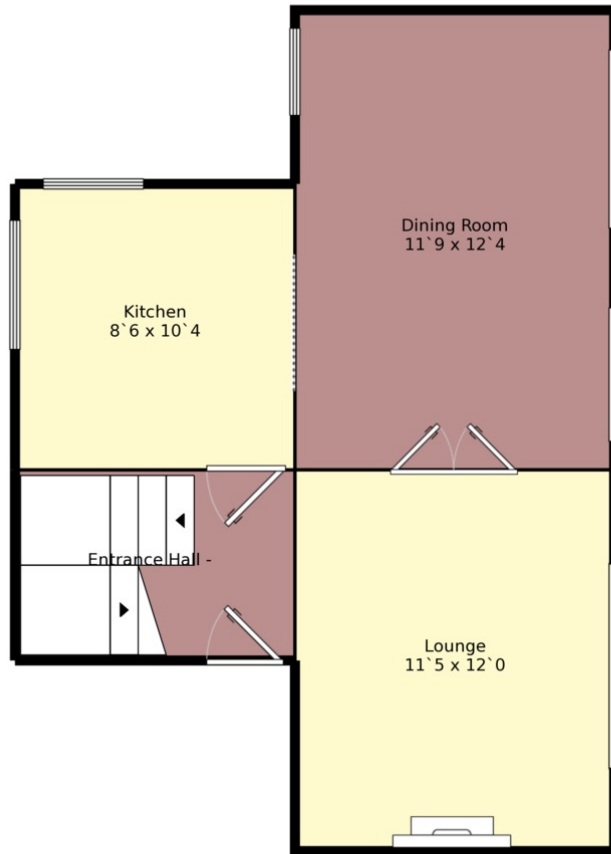

First Floor  
Floor Size: 32.0 m<sup>2</sup>, 344.4 ft<sup>2</sup>

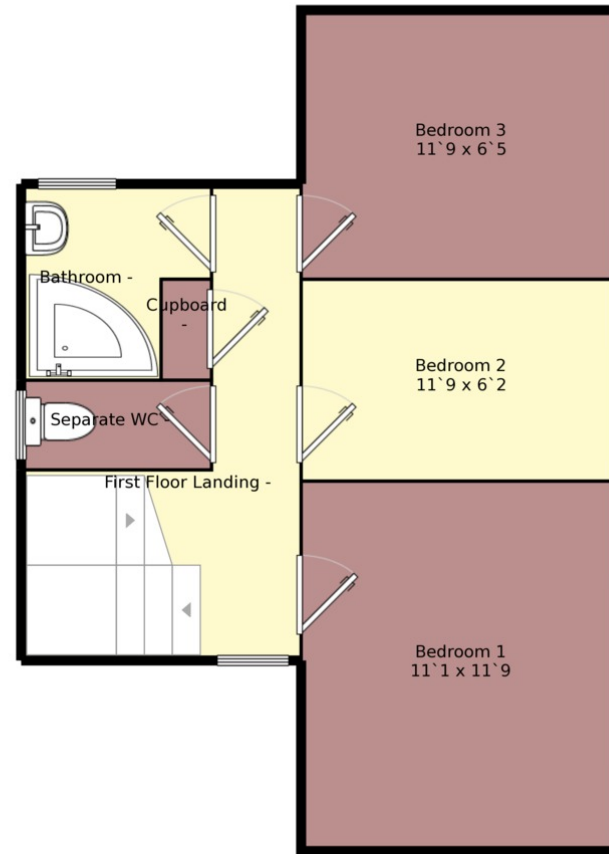

Measurements are approximate. Not to scale. For illustrative purposes only.

IMPORTANT NOTE TO PURCHASERS: We endeavour to make our sales particulars accurate and reliable, however, they do not constitute or form part of an offer or any contract and none is to be relied upon as statements of representation or fact. The services, systems and appliances listed in this specification have not been tested by us and no guarantee as to their operating ability or efficiency is given. All measurements have been taken as guide to prospective buyers only, and are not precise. Floor plans where included are not to scale and accuracy is not guaranteed. If you require clarification or further information on any points, please contact us, especially if you are travelling some distance to view. Fixtures and fittings other than those mentioned are to be agreed with the seller.

Your Move is a trading name of your-move.co.uk, registered in England at Newcastle House, Albany Court, Newcastle Business Park, Newcastle upon Tyne NE4 7YB (number 01864469).

\*Calls may be recorded and/or monitored for training and/or security purposes.

55 The Concourse, Skelmersdale, Lancashire, WN8 6LJ

01695 723334 \* Skelmersdale@your-move.co.uk

