



Forest Drive, Woodford Green, IG8





GROUND FLOOR

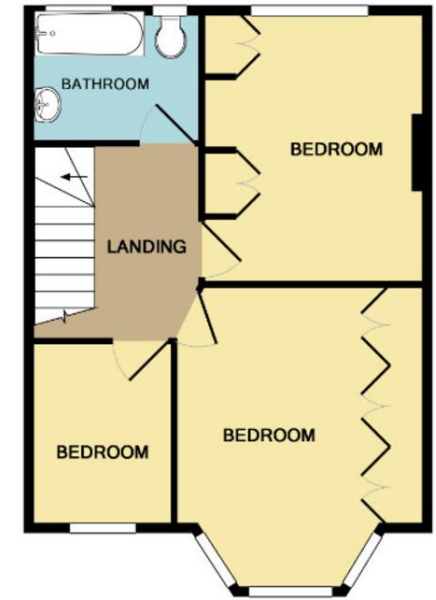

1ST FLOOR



Situated on Forest Drive, Woodford Green is this extended three bedroom semi detached family home. This attractive and well presented 1930's built property has generous accommodation throughout that includes a light and spacious hallway with a turned staircase, a large reception, a well appointed kitchen / diner, utility room and ground floor cloakroom. The first floor holds three well proportioned bedrooms and a large family bathroom. The rear garden has raised decking with steps down to lawn area, a block paved driveway offers off street parking to the front. Enjoying views over Epping Forest and being ideally located for many of the favoured local schools an early viewing is highly advised.