



Heathfield Road

REDDITCH

£170,000



Two Bedroom Mid Terraced House

Features.

- TWO DOUBLE BED ROOMS
- SHOWER ROOM
- LOUNGE
- KITCHEN/DINER
- FRONT AND REAR GARDENS
- DESIRABLE LOCATION
- NO ONWARD CHAIN

Description.

Summary: A neatly presented two double bedroom mid terraced property offered with front and rear gardens, shower room, kitchen/diner and situated in the desirable location of Webheath, Redditch.

Description: This property has been neatly maintained throughout with the accommodation briefly comprising:- A lounge with a front aspect window and feature fireplace, a kitchen/diner with a range of fitted units, space for free standing appliances and room for a table and chairs for more comfortable dining. A rising staircase leads to the first floor and offers two double bedrooms and the bathroom with shower enclosure, basin and WC.

Outside: The front aspect of the property is approached by a low maintenance fore garden and hedgerow boundaries. The rear garden is mainly laid to lawn with fenced boundaries and a raised brick built flower bed.

Location: Situated in the sought after area of Webheath, the nearby town centre of Redditch offers easy access to motorway links (M42 & M5) which allows an accessible commute to the Birmingham International Airport and NEC. There are also good rail and bus links along with numerous leisure facilities, well regarded first, middle and high schooling and neighbouring countryside.



Room Dimensions:

Lounge: 11' 11" x 11' 10" (3.65m x 3.63m)

Kitchen/Diner: 9' 11" x 11' 10" (3.03m x 3.63m)

Stairs To First Floor Landing

Master Bedroom: 7' 11" x 11' 11" (2.42m x 3.64m)

Bedroom Two: 8' 9" x 9' 10" (2.67m x 3.00m)

Shower Room: 8' 7" x 3' 8" (2.64m x 1.14m)

Please read the following: These particulars are for general guidance only and are based on information supplied and approved by the seller. Complete accuracy cannot be guaranteed and may be subject to errors and/or omissions. They do not constitute a contract or part of a contract in any way. We are not surveyors or conveyancing experts therefore we cannot and do not comment on the condition, issues relating to title or other legal issues that may affect this property. Interested parties should employ their own professionals to make enquiries before carrying out any transactional decisions. Photographs are provided for illustrative purposes only and the items shown in these are not necessarily included in the sale, unless specifically stated. The mention of any fixtures, fittings and/or appliances does not imply that they are in full efficient working order and they have not been tested. All dimensions are approximate. We are not liable for any loss arising from the use of these details.



Heathfield Road, Redditch

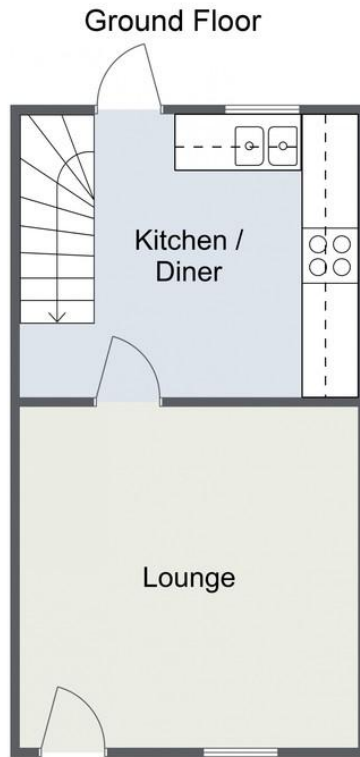

Total Area Approx
49.3 sq m
530.7 sq ft

For illustrative purposes only. Decorative finishes, fixtures & fittings do not represent the current state of the property. Measurements are approximate & not to scale. Floor Plans made using RoomSketcher.

EPC: C

COUNCIL TAX BAND: B

TENURE: Freehold

.....
For more information on this house or to arrange a viewing please call the Redditch office on:

01527 540 654

.....
Alternatively, you can scan below to view all of the details of this property online.

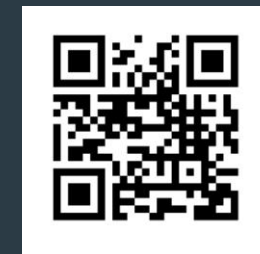

.....
373 Evesham Road
Redditch
Worcestershire
B97 5JA