





Property Summary

Smart one bedroom garden flat. Located in the Hatcham Park conservation area, New Cross. This beautiful and central flat must be seen, we have keys to show you around and the flat is chain free. Take a look. #AskBeaumont

Property Features

- GARDEN FLAT
- SPLIT LEVEL
- OWN FRONT DOOR
- DIRECT GARDEN ACCESS
- 57M2
- CONSERVATION AREA
- SMART KITCHEN
- SMART BATHROOM
- SUPER FOR TRANSPORT
- PARK WITHIN 200FT





Casella Road

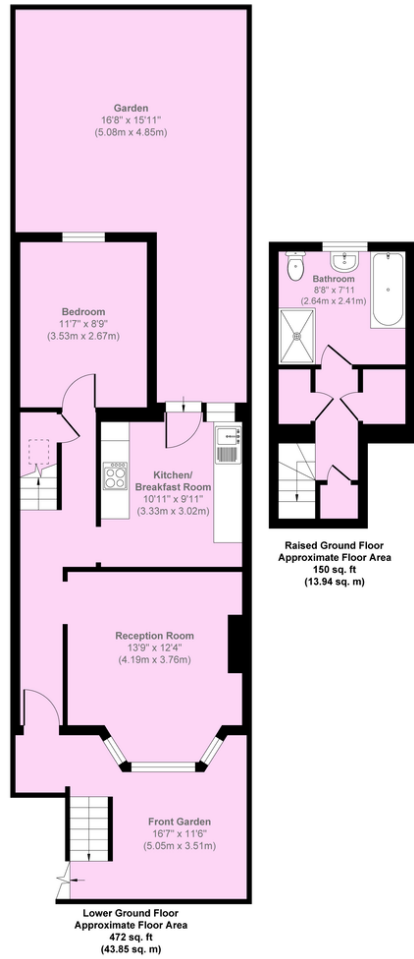

Approx. Gross Internal Floor Area 622 sq. ft / 57.79 sq. m

Illustration for identification purposes only, measurements are approximate, not to scale.

Copyright © markbeaumont.com
Produced by Elements Property

Score	Energy rating	Current	Potential
92+	A		
81-91	B		
69-80	C		
55-68	D	63 D	77 C
39-54	E		
21-38	F		
1-20	G		